

品 种
LTEM NAME: VIBRATION SWITCH
①Rating 电压与电流规格: DC 12V 1mA

型 号
PART NO: SW-392(RoHS Compliant)

②Electrical Performance 电气性能:

	Test conditions 测试条件	Performance 性能
接 触 电 阻 Contact resistance	1KHz5%, 1V. 10mA. 或 DC. 5V. 1A 1KHz±5%, 1V. 10mA. or DC. 5V. 1A	100mΩ 以下 100mΩ Max
绝 缘 电 阻 Insulation resistance	DC.500V 在 1 分钟 5 秒之内 DC.500V for 1 minute5 seconds	100MΩ 以上 More than 500MΩ
耐 电 压 Voltage proof	AC.500V(50-60Hz)在 1 分钟之内 AC.500V(50-60Hz) for 1 minute	绝缘不会破坏 Not breaking insulation

③Mcmechanical performance 机械性能:

	Test conditions 测试条件	Performance 性能
耐 久 性 (无 负 荷) Durability (without load)	无负荷 100,000 次来回,速度每分钟 15—18 次来回连续动作 100,000cycles operation at a rate of 15—18 cycles per 1 minute without load	接触电阻:100mΩ 以下 Contact resistance: 100mΩ Max 绝缘抵抗: 100MΩ 以上 Insulation resistance:More than 100MΩ 耐电压:AC.500V 1 分钟内绝不破坏 Voltage proof:AC. 500V for 1 minute not breaking insulation 作动力:规格值的+10%--30% 以内的变化 Operating force:within+10%--30% of specifications

④Endurance 耐候性能

	Test conditions 测试条件	Performance 性能
耐 湿 性 Damp heat proof	放置于温度 40±2℃, 相对湿度 90—95% 以内 48 小时后, 在常温常湿中放置 1 小时后 1 小时内测定 Having been left at a temperature of 40±2℃ and humidity of 90 to 95%rh for 48 hours, switch is furher left at normal temperature and humidity fot 1 hour, and then measurement is effected within 1 hour	接触电阻:100mΩ 以下 Contact resistance: 100mΩ Max 绝缘抵抗: 100MΩ 以上 Insulation resistance:More than 100MΩ 耐电压:AC.500V 1 分钟内绝缘无破坏现象 Voltage proof:AC. 500V for 1 minute not breaking insulation 作动力:规格值的+10%--30% 以内的变化 Operating force:within+10%--30% of specifications

- ⑤Solderability 焊锡温度: 255±5℃, 焊锡时间: 3±0.5second
- ⑥Operating temperature range 使用温度范围:-10 -- +60℃
- ⑦Coustruction 产品结构:另付图纸说明外形及尺寸之规格.

RoHS Compliant

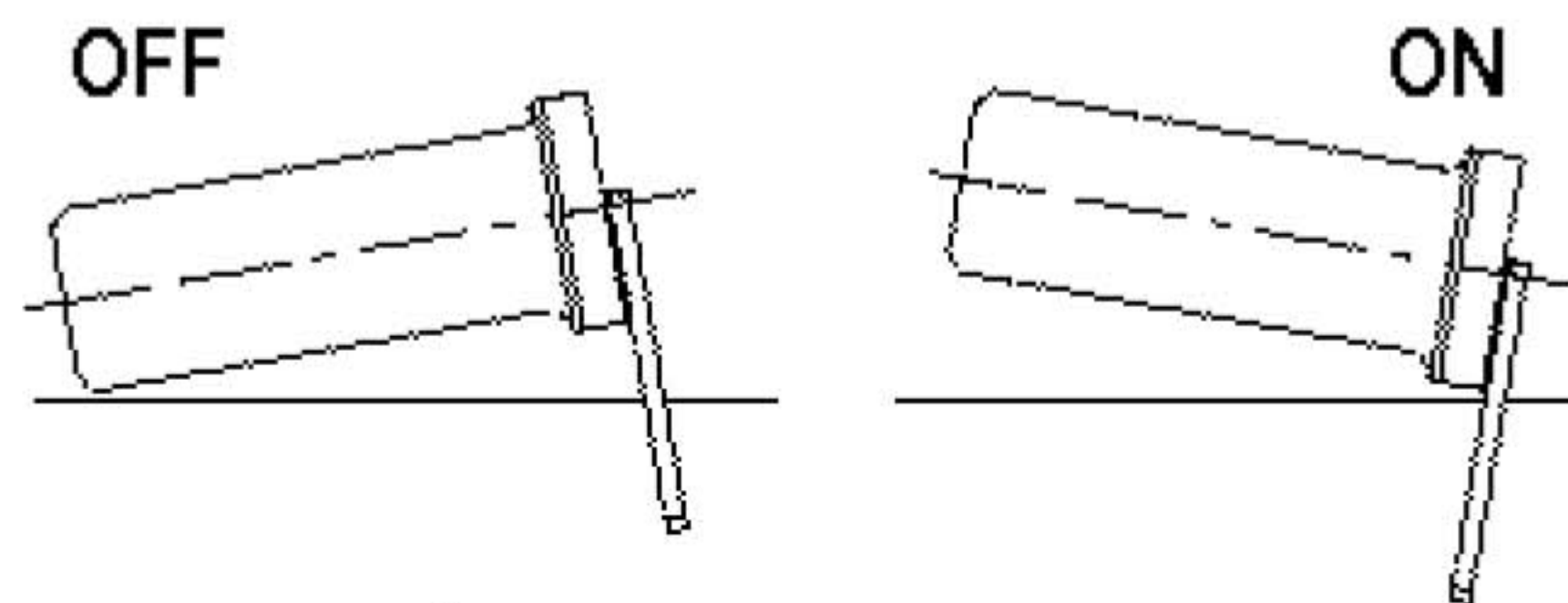
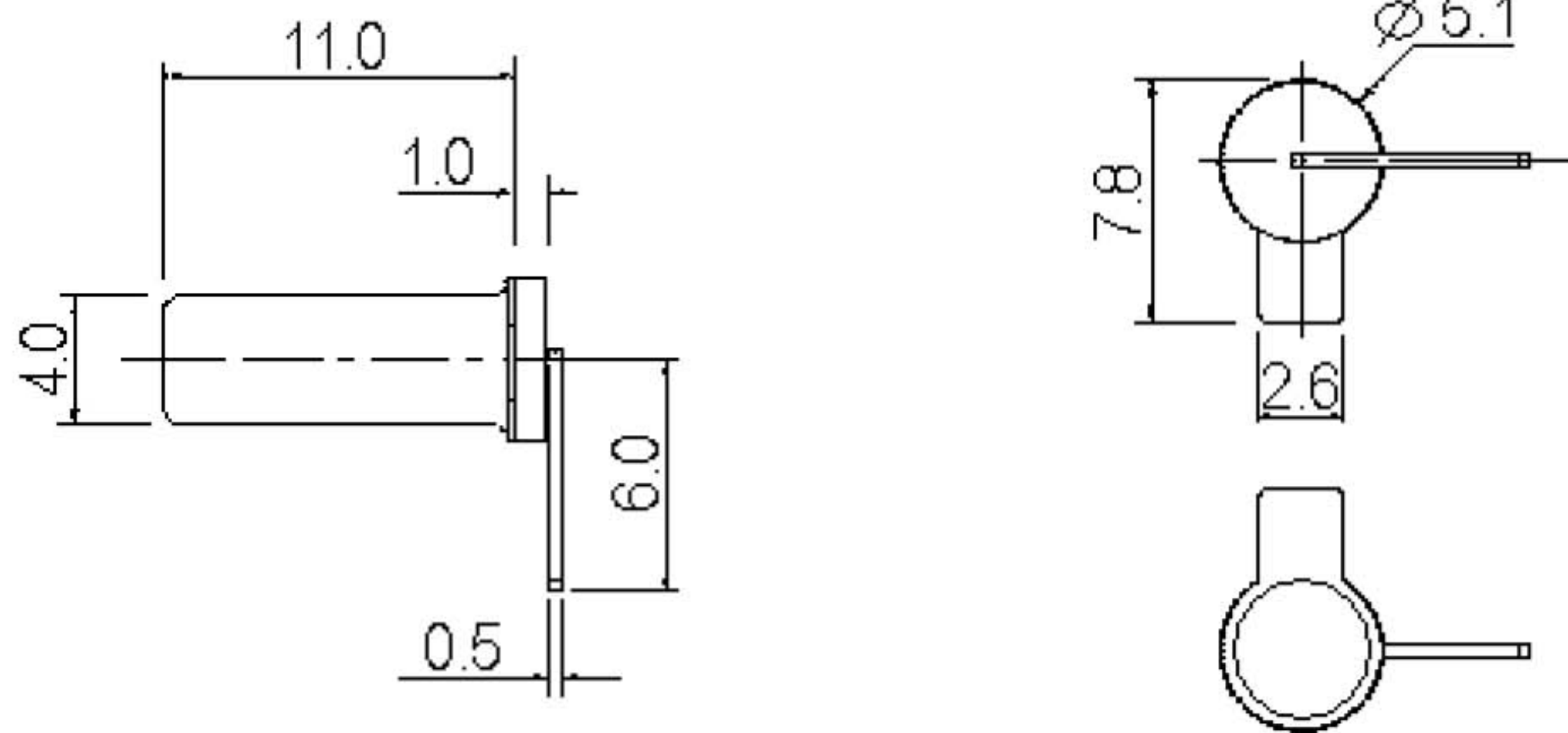

10° HAS CONTACT SIGNAL

ISSUED	SPECIFICATION	TITLE: VIBRATION SWITCH			
	RATING:DC 12V 1mA	MODEL NO: SW-392			
	CONTACT RESISTANCE:100m ohm max				
	INSULATION RESISTANCE:100M ohm at 500V DC				
	WITHSTAND VOLTAGE: AC 500V for 1 minute	UNIT: mm	DWN		
	OPERATION FORCB: Refer Attach Specification	SCALE:2:1	CHK'D		
	SWITCHING LIFE: 20000 to 300000Cycles	TOLERANCE: ± 0.2	APPD.		
BY					DRWG NO:
DATE:					VERSION 01