

Datasheet (Preliminary)

Rev. 0.7 / August 2021

TES0902 Series

(TES0902-M10)

Dual Channels NDIR CO2 Sensor Module

TES0902 series - Dual Channels NDIR CO₂ Sensor Module

Introduction

TES0902 is an ultra-small dual channels NDIR sensor module with digital interfaces for CO₂ concentration measurement.

The dual-channel NDIR CO₂ sensor module, TES0902, offers excellent performance that overcomes the drift of a light source and CO₂ over time by using Tempus' faster response NDIR sensors with its unique module structure.

TES0902 series are an ideal solution for customers seeking simple integration into user's product. TES0902-M10 is with performance of high accuracy and stability at a reasonable price. It is the individually pre-calibrated module and possible to measure CO₂ concentration up to 10,000ppm. (Other maximum concentration is available upon request).

Features

- Ultra-Small Size
- Low Power
- High Accuracy and Excellent stability
- Absolute measurement with Dual-channel NDIR sensor
- Pre-calibrated and ready-to-use
- Digital interface using RS232 and PWM
- Digital output for CO₂ level warning. (ex: Warning When >2000ppm)
- ABC feature support
- Manual Calibration support (@400ppm, 25°C)

Applications

- HVAC (Heating, Ventilation, Air-conditioning)
- Air conditioner
- Environment management system
- Indoor air quality (IAQ) control
- Automatic air ventilation system
- Smart farm

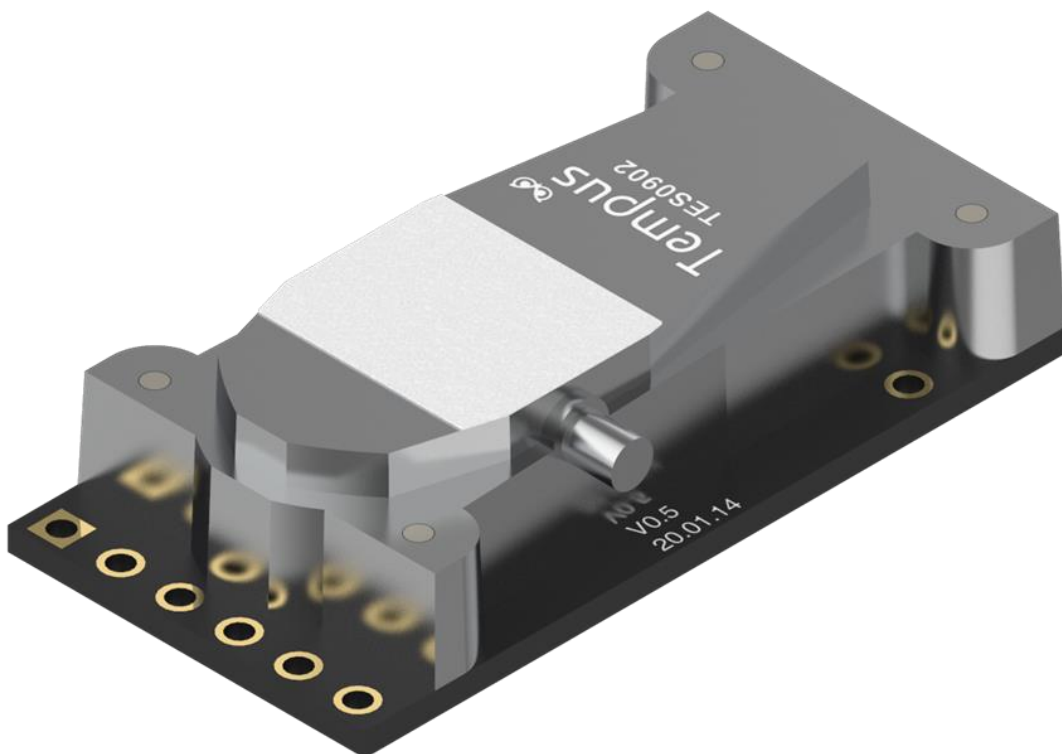

Dimension and Connector Pin Information

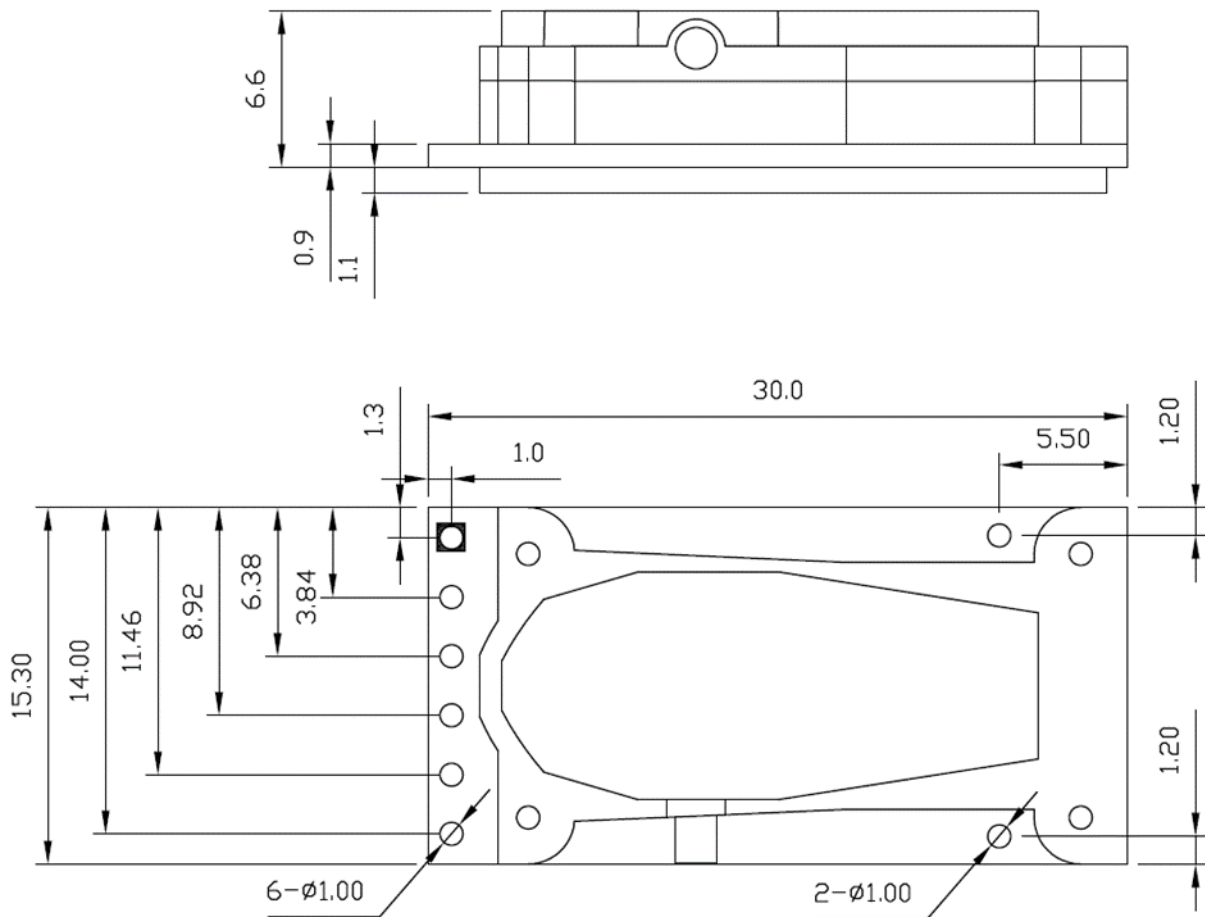

Dimension and Pin Assignment (mm, TOP View)

- * Module Total Dimension: 30.0mm (W) x 15.3mm (L) x 7.7mm (H)
- * Specification is subject to change without notice.

Pin Description

Pin No.	Pin Name	Description
1	TX	TX: 3.3V(Typ.) CMOS Level Signal
2	RX	RX: 3.3V(Typ.) CMOS Level Signal
3	+5V	+5V Input
4	GND	Ground
5	PWM	PWM Output: 3.3V(Typ.) CMOS Level Signal
6	ALARM	ALARM Signal

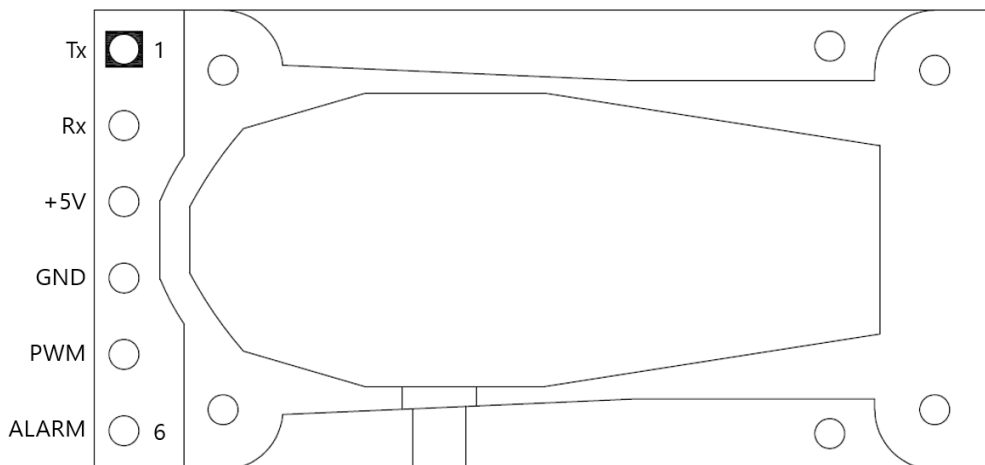

* Pin configuration is subject to change without notice.

Specifications

*Digital interface is subject to change without notice.

	Item	Specification
General	Product Name	Dual Channel NDIR CO2 sensor module
	Operation Technology	Non-dispersive Infrared(NDIR)
	Operating Temperature	-10°C ~ 50°C (Non-condensing)
	Operating Humidity	0 ~ 95% RH (Non-condensing)
	Operating Environment	Residential, Commercial spaces
	Storage Temperature	-20°C ~ 80°C(Non-condensing)
CO2 Measurement	Sensing Method	Dual Channel NDIR (Non-dispersive Infrared)
	Measurement Range	400 to 10,000 ppm
	Accuracy	400 to 5,000 ppm : $\pm(50\text{ppm} + 3\% \text{ of measured value})$ * 5,000 to 10,000 ppm : $\pm(50\text{ppm} + 5\% \text{ of measured value})$
	Warm-up Time	< 2 minutes
	Response Time	< 30 seconds (diffusion)
	Sampling Interval	2 seconds
Electrical data	Power Input	5 VDC @5% (4.75Vdc ~ 5.25Vdc) Average current 25.0 mA@5V Peak current 520mA@5V IR Lamp On 120mA@5V IR Lamp Off 10 mA@5V
	Output connector	6 pins (Terminals not mounted)
Output interface	Digital Output	RS232(UART), PWM, Alarm CMOS level output
Weight	Module Weight	2.7g

Digital Interfaces

The TES0902-M10 has several digital interfaces such as RS232, PWM, and alarm indication. Users control the register map through digital interfaces by reading and writing register values. This section describes each digital interface and the command/response map will be introduced in the next section.

1. UART Interface

TES0902-M10 support a RS232 Serial interface. Pin Rx is UART Rx (input to sensor) and Pin Tx is UART Tx (output from sensor). In details, UART Conditions are :

- 9600 Baud rates
- No Parity Bit
- 1 Stop bit
- 8 Data bits
- No Flow control

TES0902-M10 is periodically pushing ppm information to host via UART every 2 sec. Host can get more informations like version info, serial number, alarm setting via command/request data and its message format is like as below

1.1 UART Protocol

Format of the Message

UART Request Message Format

2 bytes	1 byte	1 byte	n byte	2 bytes
Sync	Command	Length	Data	Crc16

<i>Type</i>	<i>Size</i>	<i>Description</i>
Sync	2 bytes	Sync Data, 0xAA55
Command	1 byte	Command code. details in Command List
Length	1 byte	Data Size Field except CRC16
Data	n byte	Data to be transmitted
CRC16	2 bytes	Error check code

UART Response Message Format

2 bytes	1 byte	1 byte	n byte	2 bytes
Sync	Response	Length	Data	Crc16

<i>Type</i>	<i>Size</i>	<i>Description</i>
Sync	2 bytes	Sync Data, 0xBB66
Response	1 byte	Response code.
Length	1 byte	Data Size Field except CRC16
Data	n byte	Data to be reported
CRC16	2 bytes	Error check code

Host must include the **Cyclical Redundancy Check fields (CRC16)** at the end of the message for error check.

1.2 Command/Response List

<i>Name</i>	<i>Code</i>	<i>R/W</i>	<i>Data Type</i>	<i>Description</i>
CMD_GET_VER	0x10	RO	-	Read Firmware Version Information
CMD_GET_SER	0x12	RO	-	Read Serial Number
CMD_GET_PPM	0x14	RO	-	Read PPM
CMD_GET_ALARM	0x16	RO	-	Read Alarm Level
CMD_SET_ALARM	0x18	WO	uint16_t	Write Alarm Level
CMD_GET_ABC_ON	0x20	RO	-	Read ABC mode on/off
CMD_SET_ABC_ON	0x22	WO	uint16_t	Write ABC mode on/off
CMD_GET_ABC_DUR	0x24	RO	-	Read ABC Period
CMD_SET_ABC_DUR	0x26	WO	uint16_t	Write ABC Period
CMD_SET_MANUAL_CAL	0x4C	WO	-	Calibrate TES0902 to 400ppm
CMD_RESET_PWR	0x1E	WO	-	Reset power supplied to TES0902

1.3 Examples of protocol

Read PPM

0xBB	Sync (MSB)
0x66	Sync (LSB)
0x15	Response
0x02	Size
xx	Gas Concentration (LSB)
xx	Gas Concentration (MSB)
xx	CRC (LSB)
xx	CRC (MSB)

To calculate the ppm, do the following.

$$\text{PPM} = \text{MSB (HEX to DEC)} \times 256 + \text{LSB (HEX to DEC)}$$

FIRMWARE VERSION (CMD_GET_VER)

This command will return the current firmware version number.

Version number is something such as v1.1.2

Example :

Request (UART)

0xAA	Sync (MSB)
0x55	Sync (LSB)
0x10	Command
0x00	Size
xx	CRC (LSB)
xx	CRC (MSB)

Response (UART)

0xBB	Sync (MSB)
0x66	Sync (LSB)
0x11	Response
0x03	Size
xx	Major
xx	Minor
xx	Build
xx	CRC (LSB)
xx	CRC (MSB)

Example 1 – request / response to read the Firmware Version

SERIAL NUMBER (CMD_GET_SER)

This command will return serial number of the sensor. Length of serial number is 8 bytes.

Example :

Request (UART)

0xAA	Sync (MSB)
0x55	Sync (LSB)
0x12	Command
0x00	Size
xx	CRC (LSB)
xx	CRC (MSB)

Response (UART)

0xBB	Sync (MSB)
0x66	Sync (LSB)
0x13	Response
0x08	Size
xx	S/N Byte 0 (LSB)
...	...
...	...
xx	S/N Byte 7 (MSB)
xx	CRC (LSB)
xx	CRC (MSB)

Example 2 – request / response to read the Serial Number

ALARM READ (CMD_GET_ALARM)

This command will report Alarm PPM Value in Register.
By default, its value is 2,000.

Example :

Request (UART)

0xAA	Sync (MSB)
0x55	Sync (LSB)
0x16	Command
0x00	Size
xx	CRC (LSB)
xx	CRC (MSB)

Response (UART)

0xBB	Sync (MSB)
0x66	Sync (LSB)
0x17	Response
0x02	Size
xx	Alarm PPM (LSB)
xx	Alarm PPM (MSB)
xx	CRC (LSB)
xx	CRC (MSB)

Example 3 – Request / Response to read the Alarm Value in Register

ALARM WRITE (CMD_SET_ALARM)

This command will write Alarm Value in Alarm register. If value in Alarm register is 0, Alarm Function will be turned off.

Example :

Request (UART)

0xAA	Sync (MSB)
0x55	Sync (LSB)
0x18	Command
0x02	Size
xx	Alarm PPM (LSB)
xx	Alarm PPM (MSB)
xx	CRC (LSB)
xx	CRC (MSB)

Response (UART)

0xBB	Sync (MSB)
0x66	Sync (LSB)
0x19	Response
0x00	Size
xx	CRC (LSB)
xx	CRC (MSB)

Example 4 – request / response to write the Alarm Value in Register

ABC ON/OFF (CMD_GET_ABC_ON)

This command will report ABC ON state of TES0902-M10. If value is 0, ABC feature will be turned off.

Example :

Request (UART)

0xAA	Sync (MSB)
0x55	Sync (LSB)
0x20	Command
0x00	Size
Xx	CRC (LSB)
xx	CRC (MSB)

Response (UART)

0xBB	Sync (MSB)
0x66	Sync (LSB)
0x21	Response
0x02	Size
0x00	
xx	ABC ON/OFF
xx	CRC (LSB)
xx	CRC (MSB)

Example 5 – request / response to ABC feature

ABC ON/OFF (CMD_SET_ABC_ON)

This command will enable/disable ABC feature of TES0902-M10. If value is 0, ABC feature will be turned off.

Example :

Request (UART)

0xAA	Sync (MSB)
0x55	Sync (LSB)
0x22	Command
0x02	Size
0x00	
xx	ABC ON/OFF
xx	CRC (LSB)
xx	CRC (MSB)

Response (UART)

0xBB	Sync (MSB)
0x66	Sync (LSB)
0x23	Response
0x00	Size
xx	CRC (LSB)
xx	CRC (MSB)

Example 6 – request / response to ABC feature

ABC DURATION (CMD_GET_ABC_DUR)

This command will report ABC period of TES0902-M10.

Example :

Request (UART)

0xAA	Sync (MSB)
0x55	Sync (LSB)
0x24	Command
0x00	Size
xx	CRC (LSB)
xx	CRC (MSB)

Response (UART)

0xBB	Sync (MSB)
0x66	Sync (LSB)
0x25	Response
0x02	Size
xx	ABC Duration (LSB)
xx	ABC Duration (MSB)
xx	CRC (LSB)
xx	CRC (MSB)

Example 7 – request / response to ABC Duration

ABC DURATION (CMD_SET_ABC_DUR)

This command will set ABC period of TES0902-M10. By default, its value is "7" which means 7 days. Period starts from "0".

Example :

Request (UART)

0xAA	Sync (MSB)
0x55	Sync (LSB)
0x26	Command
0x02	Size
xx	ABC Duration (LSB)
xx	ABC Duration (MSB)
xx	CRC (LSB)
xx	CRC (MSB)

Response (UART)

0xBB	Sync (MSB)
0x66	Sync (LSB)
0x27	Response
0x00	Size
xx	CRC (LSB)
xx	CRC (MSB)

Example 8 – request / response to ABC Duration

MANUAL CALIBRATION (CMD_SET_MANUAL_CAL)

This command will calibrate TES0902 to 400ppm. At this moment, the environment temperature should be set to 25°C.

Example :

Request (UART)

0xAA	Sync (MSB)
0x55	Sync (LSB)
0x4C	Command
0x00	Size
xx	CRC (LSB)
xx	CRC (MSB)

Response (UART)

0xBB	Sync (MSB)
0x66	Sync (LSB)
0x4D	Response
0x00	Size
xx	CRC (LSB)
xx	CRC (MSB)

Example 9 – request / response to set Manual Calibration

POWER RESET (CMD_RESET_PWR)

This command will reset the power supplied to TES0902. It is not resetting the value of the register, but re-applying power.

Therefore, re-supplying power to the sensor does not change the ABC on/off setting, ABC duration, ABC offset, or alarm, and the value set by the user is loaded as it was.

For example, if the user sends a command to set the ABC duration to 1 day before re-supplying the power, the ABC duration remains as 1 day even if power is supplied again.

However, the time counter used to check whether the ABC duration has passed is stored in RAM, not flash. So when power is supplied again, the count is lost, and it starts again from 0.

For example, if the ABC duration is 7 days, and the sensor is powered on continuously for 5 days and then powered off, the ABC calibration will not be performed after 2 days after the next power is supplied, but it will be performed after 7days.

Example :

Request (UART)

0xAA	Sync (MSB)
0x55	Sync (LSB)
0x1E	Command
0x00	Size
xx	CRC (LSB)
xx	CRC (MSB)

Example 10 – request to reset the power supplied to TES0902

Response (UART)

No response. After sending this command, the power is reset immediately.

1.4 CRC API

```
uint16_t Calculate_CRC16 ( uint8_t *cmd , int cmd_length )
{
    uint16_t ret = 0xffff , polynomial = 0xa001 ;
    int shift = 0x0;
    for ( int i = cmd_length - 1 ; i >= 0 ; i-- ) {
        uint16_t code = ( uint16_t )( cmd [ cmd_length - 1 - i ] & 0xff );
        ret = ret ^ code ;
        shift = 0x0;
        while ( shift <= 7 ) {
            if ( ret & 0x1 ) {
                ret = ret >> 1;
                ret = ret ^ polynomial ;
            } else {
                ret = ret >> 1;
            }
            shift++;
        }
    }
    return ret;
}
```

2. PWM Operation

PWM(Pulse Width Modulation) signal is a digital signal which is equivalent to analog output in power.

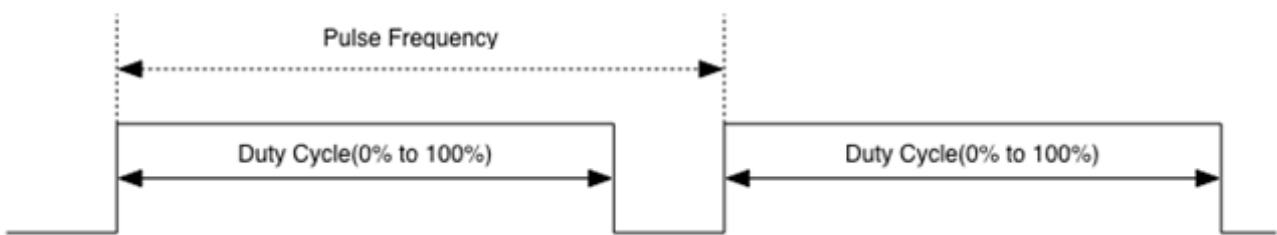

A general ADC is able to read PWM output through a LPF. The circuit shows generic first order low pass filter for converting PWM to analog signal to read it through an analog to digital converter.

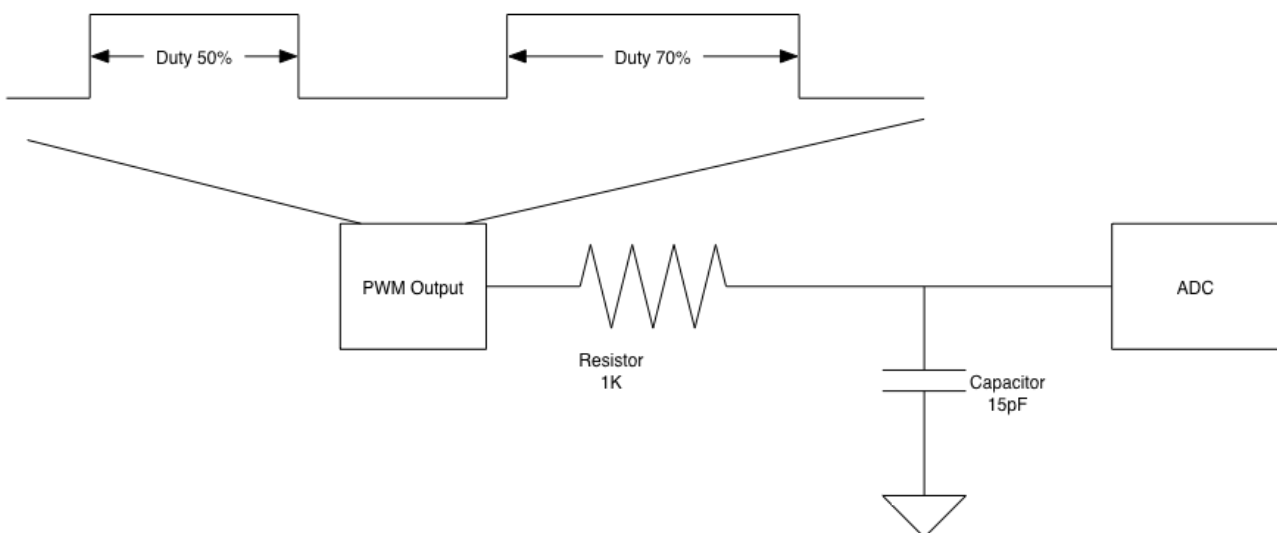

Simplified Low Pass Filter for PWM signal input to an ADC

TES0902-M10 PWM output will be proportional to a 400 to 5000 ppm and operate at 0.8Hz. The user can measure the duration of PWM pulse.

TOTAL PERIOD	1251.0 ms
OUTPUT range	400 to 5000 ppm ^{*(1)}
CO2 Level	$C_{ppm} = (PWM\ ON - 0.5) / (1250 / 5000)$

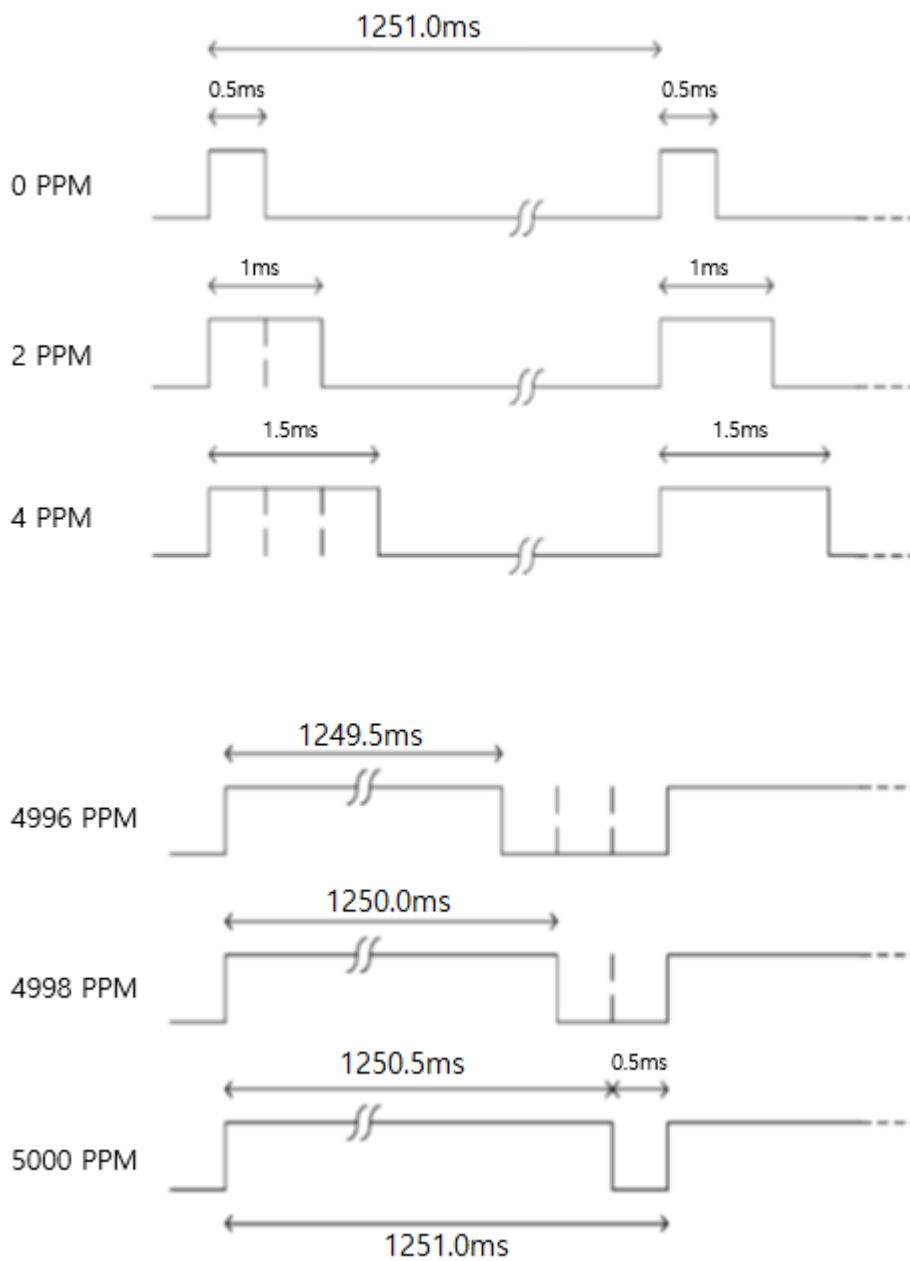

*(1) 400 ppm is the minimum value when ABC is on.

ALARM Operation

An alarm signal output is controlled by setting register addresses. This register stores CO₂ level to be alarmed and its default level is 2,000 ppm. Host can change its ALARM level via command and can enabled/disable of function. It has hysteresis area when there is alarmed.

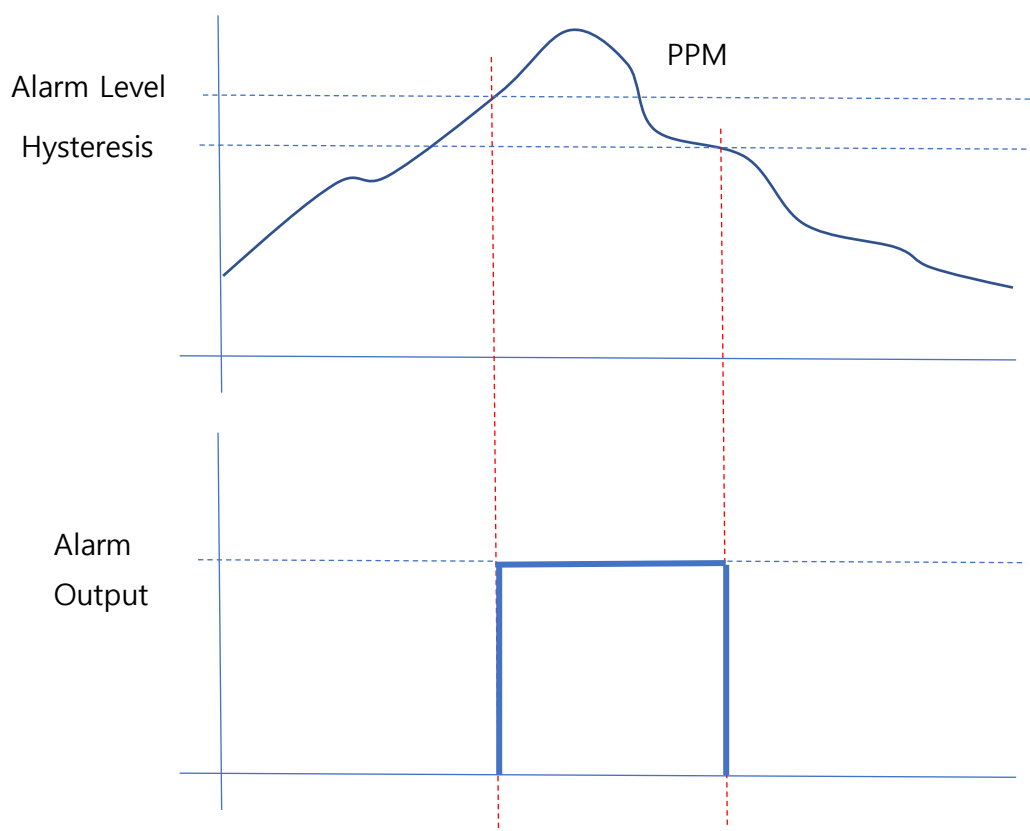

3. ABC feature

TES0902-M10 supports ABC (Automatic Background Calibration) feature.

TES0902-M10 monitors the trends and min/max value of CO2 ppm, and counts its timeframe.

Once its time count reaches at "ABC Period", ABC algorithm will apply and count its timeframe from zero again.

Its time counting is working while its power is supplying, so in case of its power is off and on, its time counting starts from zero again and counter will be reset.

So, if user wants to make ABC feature working, need to keep power on without off.

User can enable or disable ABC feature by "0x22" command set with given 1-byte option value.

By default, its ABC feature is "ON".

Please refer to the [ABC_ONOFF](#).

Also, user can change its ABC duration by "0x26" command set with given duration value.

By default, its ABC duration is "7" and its range is "0 ~ 30".

Please refer to the [ABC_DURATION](#).

4. Manual Calibration feature

TES0902 supports Manual Calibration (MC).

Due to shock during the transportation or incorrect installation, TES0902 can drift to unrelated ambient concentrations.

Manual Calibration compensates the drift to 400ppm immediately.

For accuracy compensation, TES0902 should be supplied power at least 3 minutes in a well-ventilated and stable environment prior to calibration. Also, it should be done at room temperature.

MC updates calibration parameters permanently unlike ABC.

If the user wants to calibrate the sensor without using ABC, MC is the best way.

User can manually calibrate the sensor to 400ppm via the "0x4C" command set.

Please refer to the [MANUAL_CAL](#).

5. Stop ppm push

By default, TES0902-M10 pushes ppm value periodically to host, every 2 sec, so host doesn't need any action to get ppm value.

If host doesn't need ppm push, that is, if host wants to get ppm whenever host requests, there is a way to do this via CMD_GET_PPM, 0x14 or CMD_GET_VER, 0x10.

While TES0902-M10 is pushing ppm periodically, if host sends CMD_GET_PPM or CMD_GET_VER, ppm pushing will stop and no more ppm data will be pushed.

After then, host can read ppm data by sending CMD_GET_PPM command.

If host wants to enable ppm pushing feature again, try to reset TES0902-M10 module.

Example :

Request (UART)

0xAA	Sync (MSB)
0x55	Sync (LSB)
0x14	Command
0x00	Size
xx	CRC (LSB)
xx	CRC (MSB)

Response (UART)

0xBB	Sync (MSB)
0x66	Sync (LSB)
0x15	Response
0x02	Size
xx	Gas Concentration (LSB)
xx	Gas Concentration (MSB)
xx	CRC (LSB)
xx	CRC (MSB)