

Rev.	Date	Description
A	2004/10/14	New Drawing

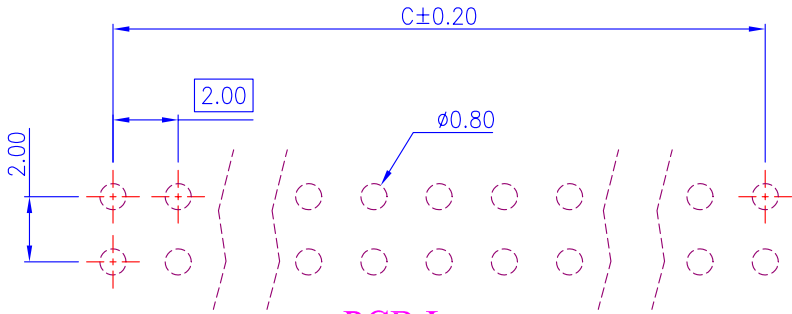

PCB Layout
(Top View)

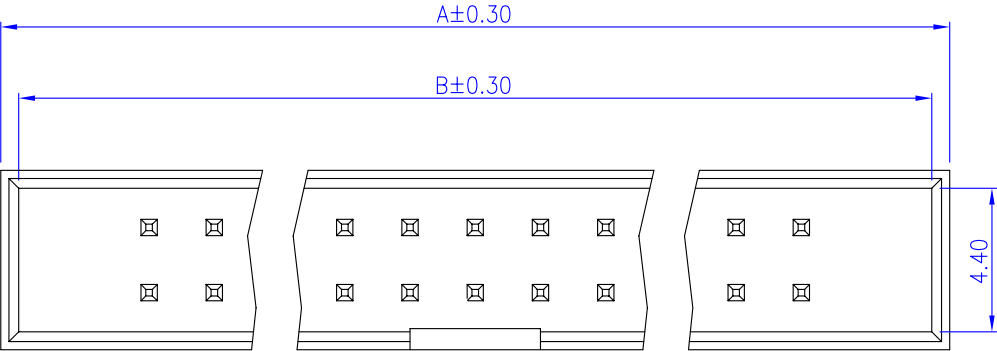
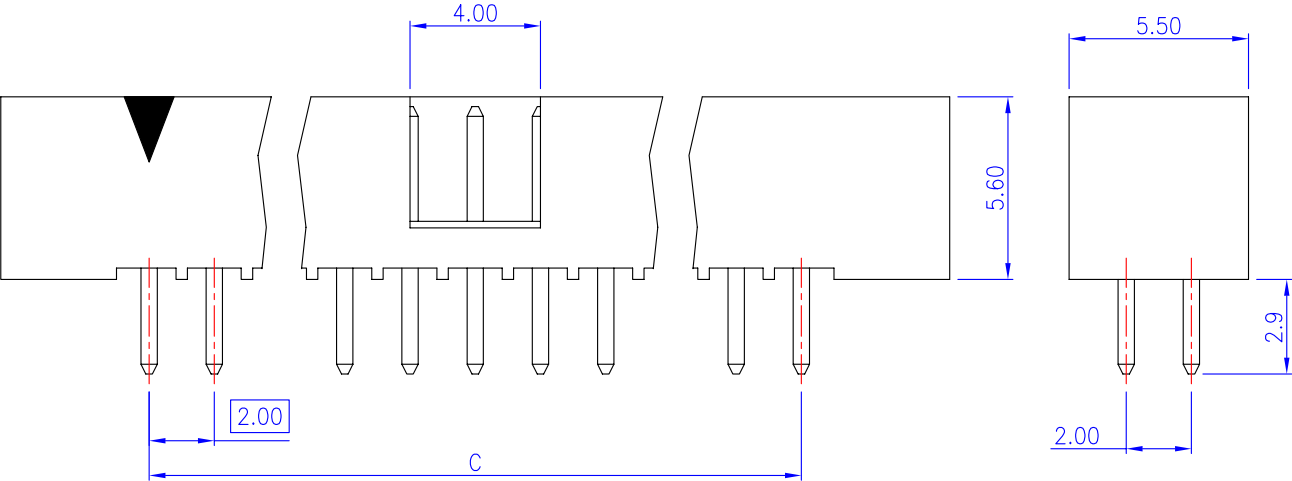

Order Information	Dimensions				Order Information	Dimensions			
	Pos.	A	B	C		Pos.	A	B	C
221601-00203	06	13.20	12.10	4.00	221601-00214	28	35.20	34.10	26.00
221601-00204	08	15.20	14.10	6.00	221601-00215	30	37.20	36.10	28.00
221601-00205	10	17.20	16.10	8.00	221601-00216	32	39.20	38.10	30.00
221601-00206	12	19.20	18.10	10.00	221601-00217	34	41.20	40.10	32.00
221601-00207	14	21.20	20.10	12.00	221601-00218	36	43.20	42.10	34.00
221601-00208	16	23.20	22.10	14.00	221601-00220	40	47.20	46.10	38.00
221601-00209	18	25.20	24.10	16.00	221601-00222	44	51.20	50.10	42.00
221601-00210	20	27.20	26.10	18.00	221601-00225	50	57.20	56.10	48.00
221601-00211	22	29.20	28.10	20.00	221601-00230	60	67.20	66.10	58.00
221601-00212	24	31.20	30.10	22.00	221601-00232	64	71.20	70.10	62.00
221601-00213	26	33.20	32.10	24.00	221601-00234	68	75.20	74.10	66.00



宏達企業有限公司
HONG-DA CO., LTD.

Material and Finish

- Housing: Thermoplastic (UL94V-0), Black.
- Terminal: Sq. 0.50mm Copper Alloy, Gold Plating

Electrical Characteristics

- Current Rating: 1.0 Amp. Max..
- Dielectric Withstand Voltage:
800V AC RMS for 60Seconds.
- Insulation Resistance:
1000M Ohms Min. at 500V DC.

Mechanical Characteristics

- Operating Temperature: -55°C ~ +105°C

Tolerance	Scale	Unit	Drawn By	Checked By	Approved By
0.0 ±0.30 0.00 ±0.20 0.000 ±0.10	1:1	mm	Naosei	Scott	Alex
HD221601					
2.00mm Box Header PCB Mount Vertical Dual Rows					