

SPECIFICATION

Product Name: Solid State Relay

Model: XSSR-DD25100W2

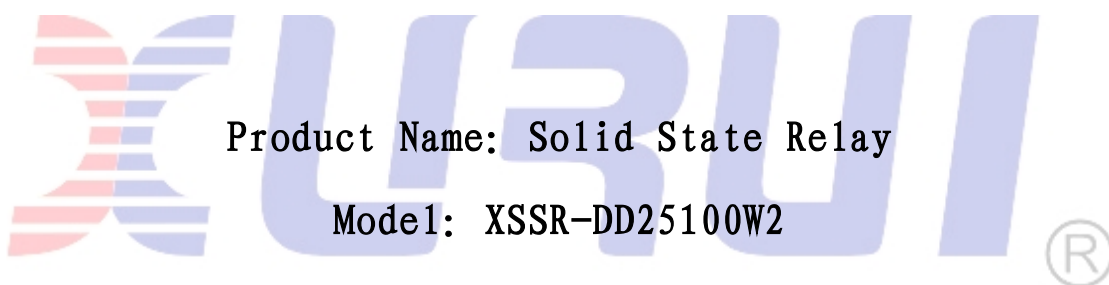

ZHEJIANG XURUI ELECTRONIC CO.,LTD

1. Features & Application

Electro-optic isolation between input circuit and output circuit.

The control signal and TTL CMOS Logic is compatible.

The bidirectional control silicon output and zero circuit shutdown.

Plug-in connector welding, small size and easy mounting.

Widely used in industrial auto system, computer periphery connection, intermediate relay, solenoid valve control, etc.

2. Model & Meanings

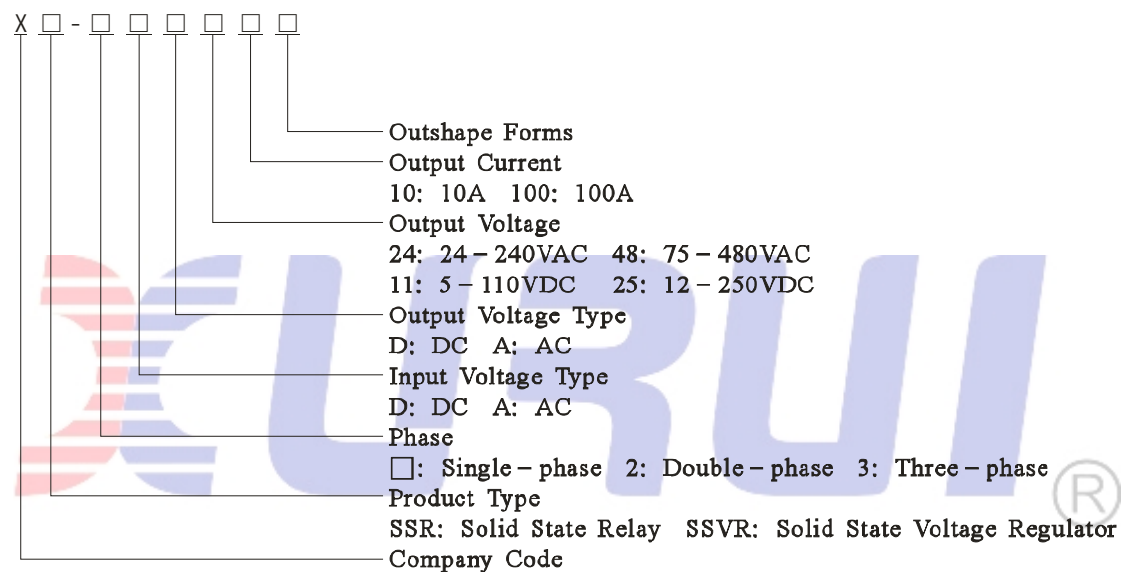

3. Technical Specification

| Item | Data |
|--------------------------|-----------|
| Control voltage | 5-30VDC |
| Control current | 4-25mA |
| Reverse Voltage | 30VDC |
| Guarantee Close Voltage | 2VDC |
| Guarantee Open Voltage | 5VDC |
| Load Voltage | 12-250VDC |
| Load max current | 100A |
| Load mini current | 0.08A |
| Breakover Voltage | ≤2VDC |
| Output leakage current | ≤1mA |
| Medium withstand voltage | ≥2500VAC |
| Insulating resistance | ≥100MΩ |
| Switch time | ≤5mS |

| | |
|----------------------------|---|
| Working temperature | -25°C-70°C |
| Humidity | ≤85% |
| Load current safety factor | Resistive load 40-50% , Inductive load 20-30% |

4. Outshape and mounting dimensions.

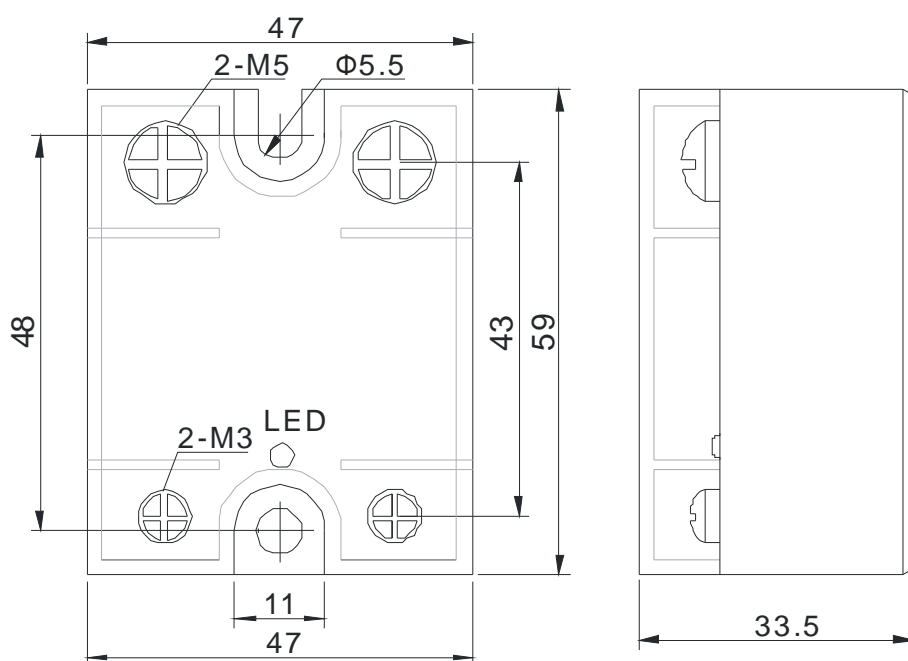

5. Connection Diagram

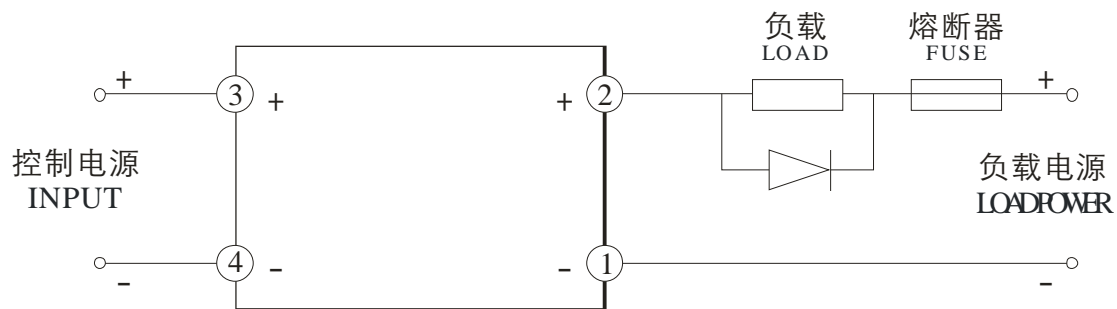

6. Application attentions

- Control voltage and working voltage must be stable, the coefficient of fluctuation should guarantee in 10% , when wiring should pay attention to the solid state relay's polarity to avoid wrong connection causing solid state relay permanence Damage. SSR should be mounted away from origin of heat and good radiating conditions. In the case that the ambient temperatures is too high or bad radiating condition, it should increase the current margin to ensure SSR good working. In the case that the ambient temperatures is too high or bad radiating condition, it should increase the current margin to ensure SSR good working. SSR can be even and good radiating. When mounting SSR, fastener must be tightened to prevent increasing resistance caused by screw loosening. Even spreads heat conduction silicon , maintains the solid state relay can be even good radiation.
- Should use the corresponding overflow and the overvoltage protection measure. Overflow protection may select the fast fuse that response time is 10 μ S. Fuse size choose the practical work current 1.2-1.5 times. Overvoltage protection may use RC resistance-capacitance absorbing circuit and varistor. This series SSR has built in RC resistance-capacitance. Varistor choosing may according to the working voltage and current. 220V voltage select the varistor of 430-470V, 380V voltage select the varistor of 750-820V, the varistor discharge current capacity choose according to the current size.

7. Certifications

CE