

NPI(M) SERIES

DIMENSIONS

NPI(R)

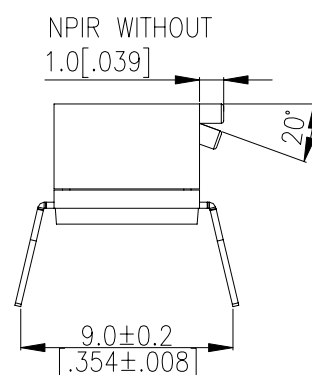
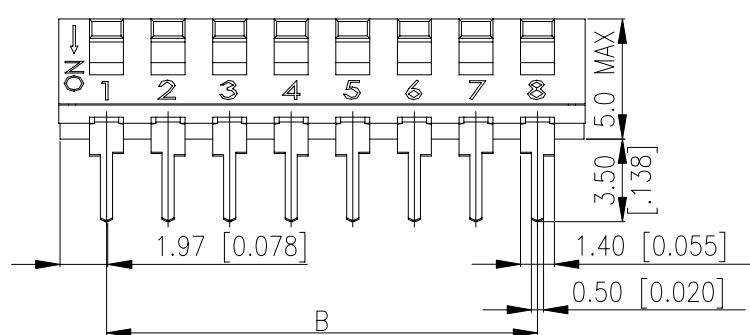
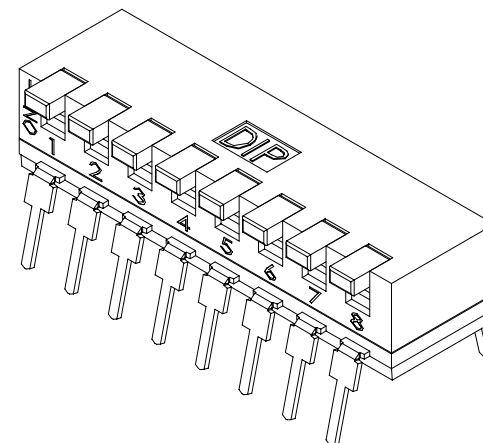
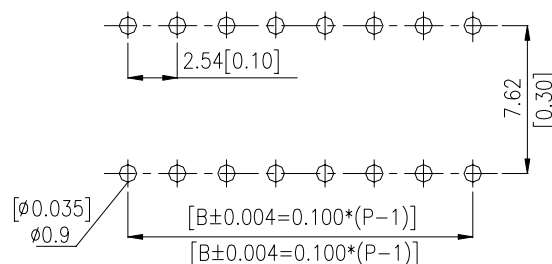
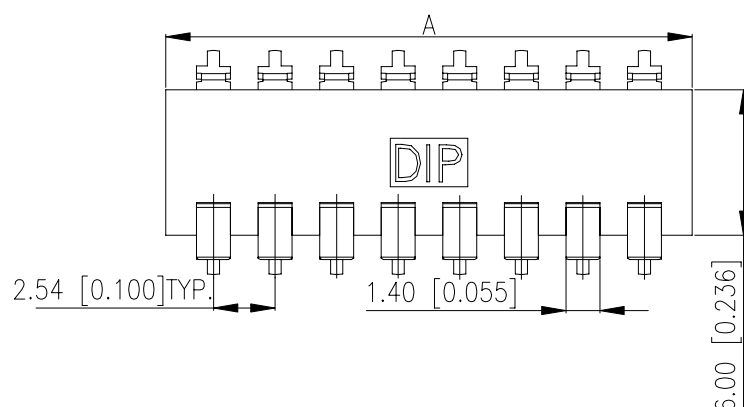

NPI(R)-10-V	10	26.80[1.055]	22.86[.900]
NPI(R)-08-V	8	21.72[.855]	17.78[.700]
NPI(R)-06-V	6	16.64[.655]	12.70[.500]
NPI(R)-04-V	4	11.56[.455]	7.62[.300]
NPI(R)-02-V	2	6.48[.255]	2.54[.100]
PROD. NO.	NO. OF POS.	DIM. A	DIM. B

SCHEMATIC(TYP.)

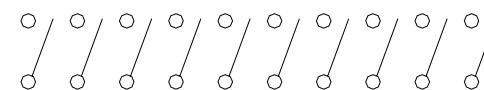

CIRCUIT DIAGRAM

****GENERAL TOLERANCES MAX:±0.2mm.****

NPM(R)

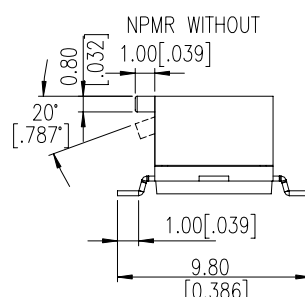
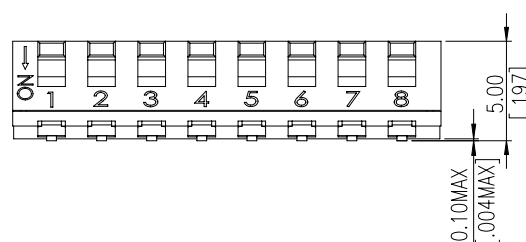
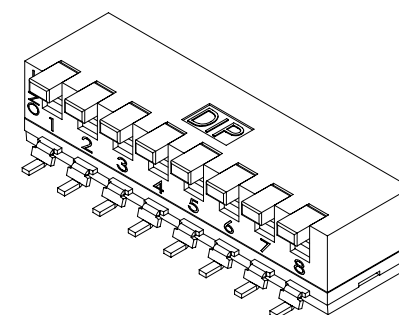
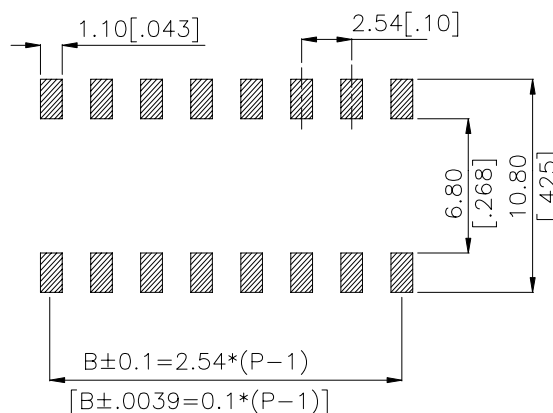
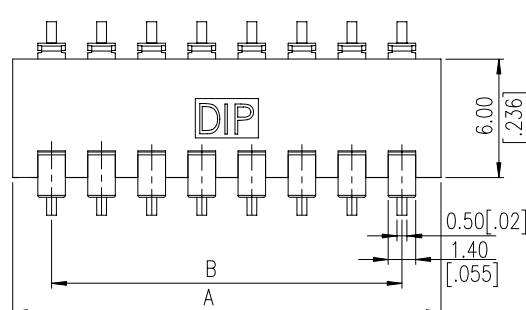

NPM(R)-10-V	10	26.80[1.055]	22.86[.900]
NPM(R)-08-V	8	21.72[.855]	17.78[.700]
NPM(R)-06-V	6	16.64[.655]	12.70[.500]
NPM(R)-04-V	4	11.56[.455]	7.62[.300]
NPM(R)-02-V	2	6.48[.255]	2.54[.100]
PROD. NO.	NO. OF POS.	DIM. A	DIM. B

SCHEMATIC(TYP.)



CIRCUIT DIAGRAM

****GENERAL TOLERANCES MAX:±0.2mm.****

HOW TO ORDER

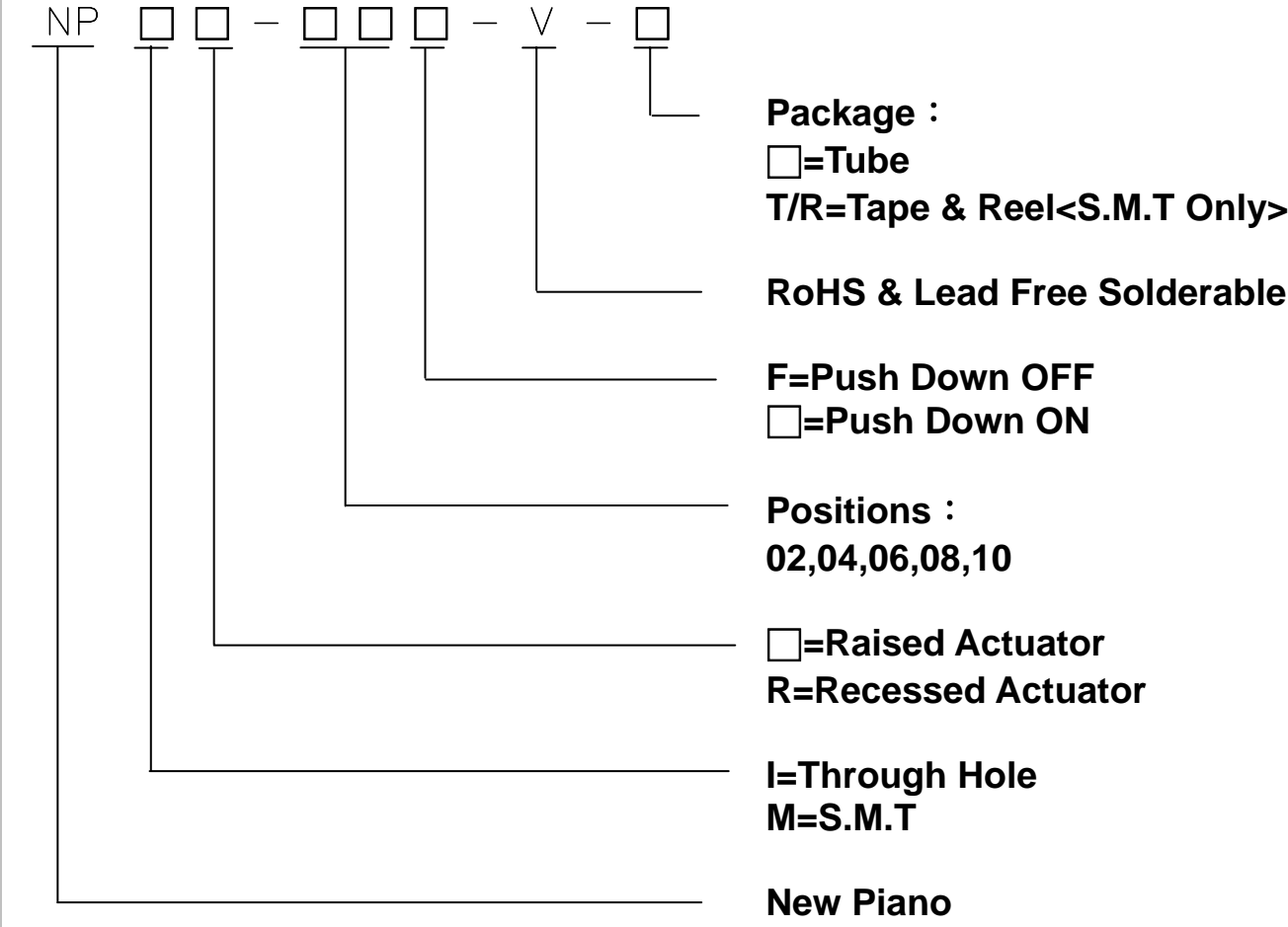

SPECIFICATION

- △

MECHANICAL

Mechanical Life : 2,000 cycles.

Operation Force : 800gf max.

Operation Temperature Range : -20℃ to +85℃

Storage Temperature Range : -40℃ to +85℃
- △

ELECTRICAL

Electrical Life : 2,000 cycles.

Switching Rating : 25mA,24VDC

Contact resistance : 100mΩ max. , at 500 VDC.

Insulation Resistance : 100MΩ max, at 500 VDC.

Dielectric Strength : 100VAC/1 minute.

MATERIAL

- △

Actuator : High-Temp Thermoplastic LCP

Color : White
- △

Contact : Alloy Copper with gold plated.
- △

Base : High-Temp Thermoplastic NYLON UL 94V-0

Color : Black
- △

Cover : High-Temp Thermoplastic NYLON UL 94V-0

Color : Black
- △

Terminal : Brass, Gold Plated

SOLDERING PROCESS

△CLEANING:

- 1. Only Tape sealed types apply to wash process.
- 2. Do not remove the tape before wash process.
- 3. After soldering process, do not continue the wash process immediately. Please wait for at least 3 minutes.
- 4. Apply alcoholic solvents as cleaning agent do not use other solvents or water.
- 5. Ultrasonic cleaning is not recommended.
- 6. The cleaning process per stage is max. 1 minute and the whole cleaning time are not to exceed 3 minutes.
- 7. Do not impose any external force on switch while washing.

△ Any flux enters the switch may fail the conductivity.

△Reflow Temperature Profile: （reference）

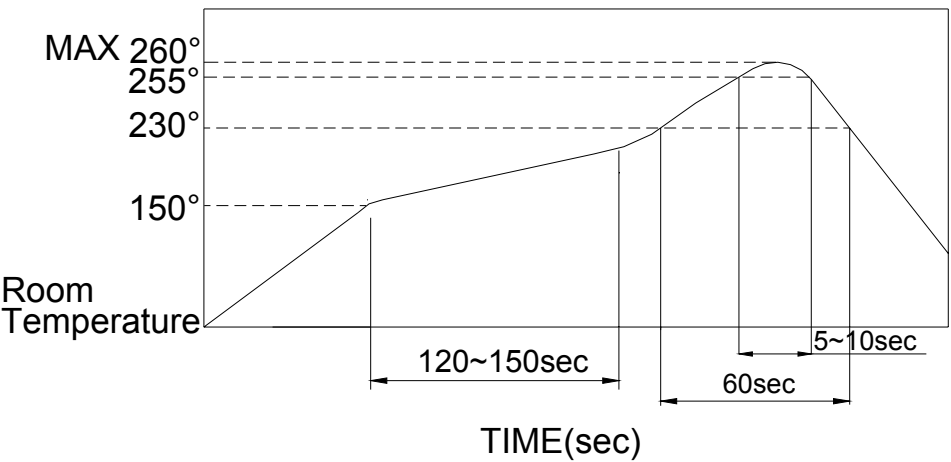

PACKING

NPM CARRIER

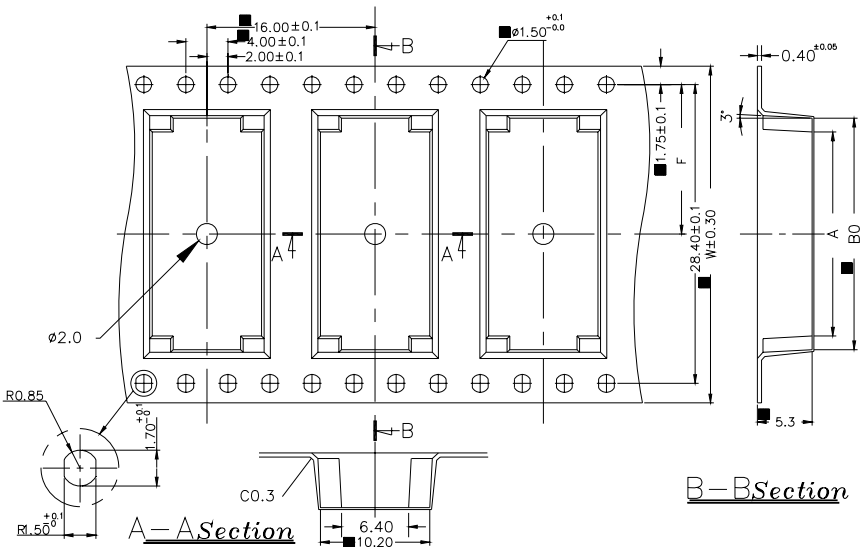

6271A0000	NPM-10	27.18	24.63	44.00	20.20
627180000	NPM-08	22.10	19.55	32.00	14.20
627160000	NPM-06	17.02	14.47	24.00	11.50
627140000	NPM-04	11.94	9.39	24.00	7.50
627120000	NPM-02	6.86	4.31	16.00	5.50
PART NO:		BO	A	W	F

GENERAL TOLERANCES MAX:±0.1mm.

NPI TUBE

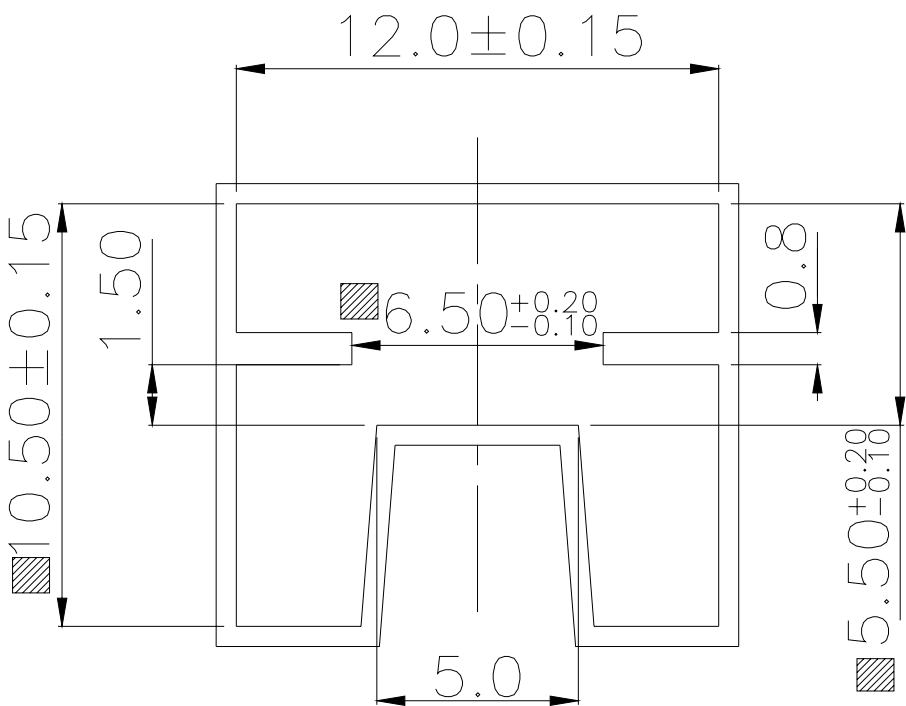

GENERAL TOLERANCES MAX:±0.2mm.

NPM TUBE

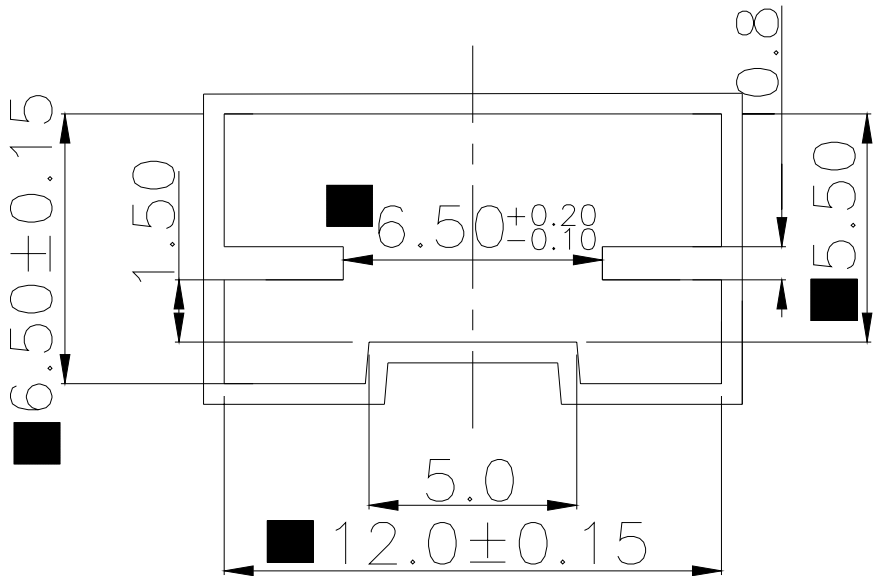

GENERAL TOLERANCES MAX:±0.20mm.

Part Number	Number Per Tube	Number Per Reel
NPI(R)-02	70	
NPI(R)-04	40	
NPI(R)-06	28	
NPI(R)-08	20	
NPI(R)-10	16	
NPM(R)-02	70	700
NPM(R)-04	40	700
NPM(R)-06	28	700
NPM(R)-08	20	700
NPM(R)-10	16	700