



Features:

1. 18MM Round.
2. Low power requirement.
3. Excellent characters appearance.
4. Solid state reliability.
5. Categorized for luminous intensity.
6. Duplex drive no common polar.

Description:

1. The High Red(**S**) source color devices are made with Gallium Arsenide Phosphide on Gallium Phosphide Orange Light Emitting Diode.
The Yellow Green(**G**) source color devices are made with Gallium Phosphide Green light Emitting Diode.
The Yellow(**Y**) source color devices are made with Gallium Arsenide Phosphide on Gallium Phosphide Yellow Light Emitting Diode.
The Super Bright Red(**SR**) source color devices are made with Gallium Aluminum Arsenide Red Light Emitting Diode.
2. The product have a white/red/green/yellow lens.



Package Dimensions:

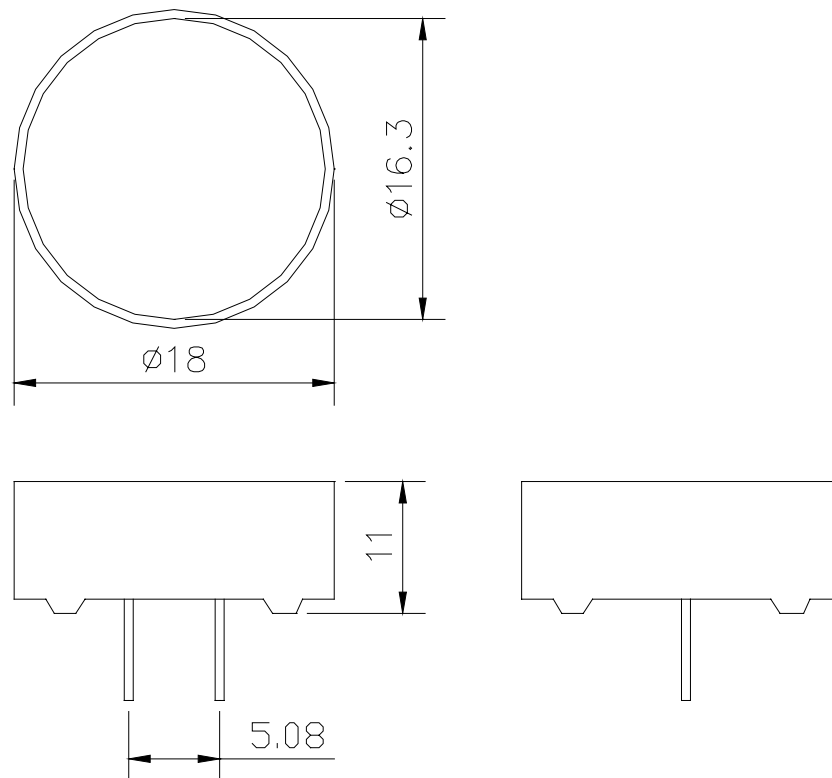

Internal Circuit Diagram:

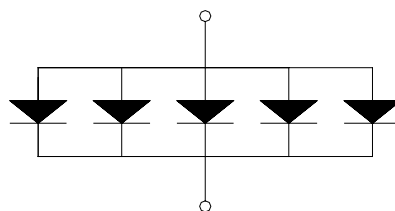



漳州市晶艺佳电子制造有限公司

ZhangZhou Jingyijia Electronic Manufacture Co.,Ltd.

ULA- 18X

18mm LIGHT BAR

Selection Guide

Part No.	Dice	Iv(mcd)		Description
		Min.	Typ.	
ULA- 18S	HIGH RED(GaAsP/GaP)	10	12	Polar
ULA- 18Y	YELLOW GREEN (GaP)	13	16	Polar
ULA- 18G	YELLOW(GaAsP/GaP)	11	14	Polar
ULA- 18SR	SUPER BRIGHT RED (GaAlAs)	30	40	Polar

Electrical/Optical Characteristics at Ta=25

Symbol	Parameter	Device	Typ.	Max.	Units	Test Conditions
peak	Peak Wavelength	High Red Yellow Green Yellow Super Bright Red	640 565 590 660		nm	IF=20mA
D	Dominate Wavelength	High Red Yellow Green Yellow Super Bright Red	638 568 588 640		nm	IF=20mA
1/2	Spectral Line Halfwidth	High Red Yellow Green Yellow Super Bright Red	45 30 35 20		nm	IF=20mA
C	Capacitance	High Red Yellow Green Yellow Super Bright Red	15 15 20 45		pF	VF=0V;f=1MHz
VF	Forward Voltage	High Red Yellow Green Yellow Super Bright Red	1.8 2.2 2.0 1.8	2.2 2.4 2.2 2.3	V	IF=20mA
IR	Reverse Current	All		10	uA	VR=5V

Absolute Maximum Ratings at Ta=25

Parameter	High Red	Yellow Green	Yellow	Super Bright Red	Units
Power Dissipation	105	105	105	100	mW
DC Forward Current	30	25	25	25	mA
Peak Forward Current[1]	150	150	150	150	mA
Reverse Voltage	5	5	5	5	V
Operating/Storage Temperature	-40 To +85				
Lead Solder Temperature[2]	260 For 5 Seconds				

Notes:

- 1/10 Duty Cycle, 0.1ms Pulse Width.
- 4mm below package base



漳州市晶艺佳电子制造有限公司

ZhangZhou Jingyijia Electronic Manufacture Co.,Ltd.

ULA- 18X

18mm LIGHT BAR

TYPICAL ELECTRO-OPTICAL CHARACTERISTICS CURVE:

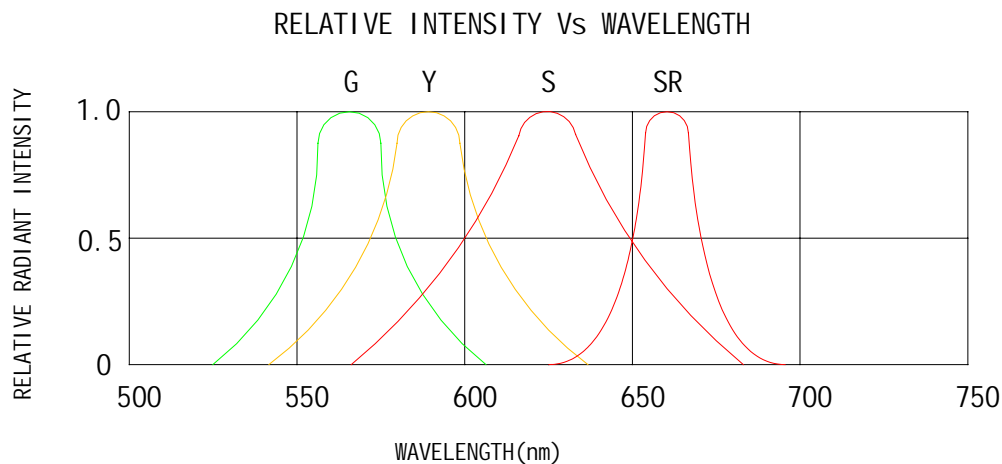

High Red

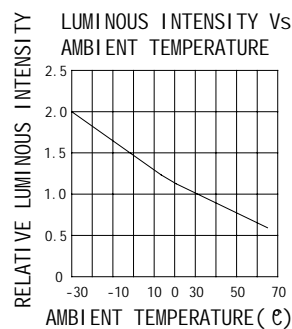
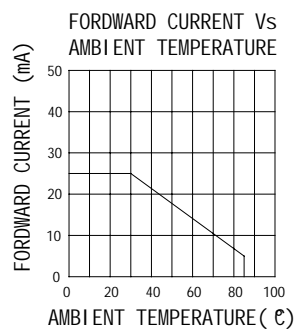
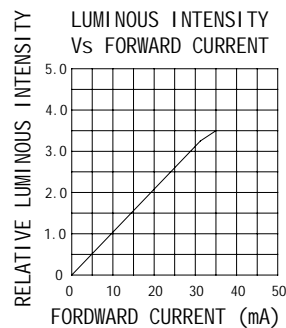
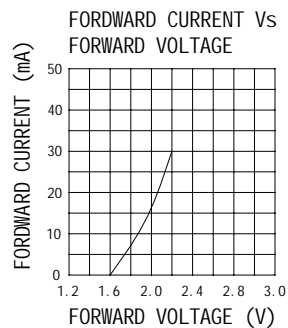



漳州市晶艺佳电子制造有限公司

ZhangZhou Jingyijia Electronic Manufacture Co.,Ltd.

ULA- 18X

18mm LIGHT BAR

Yellow Green

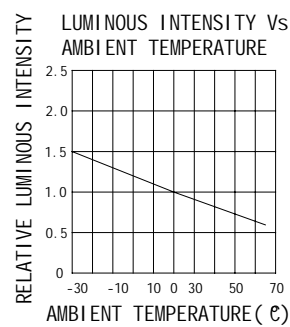
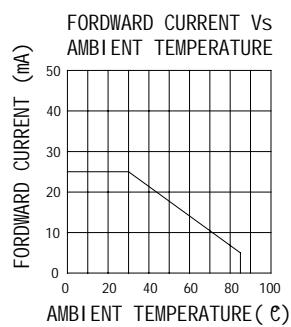
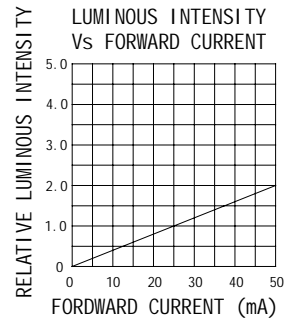
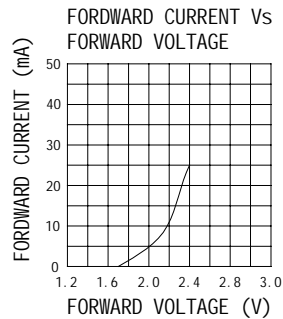

Yellow

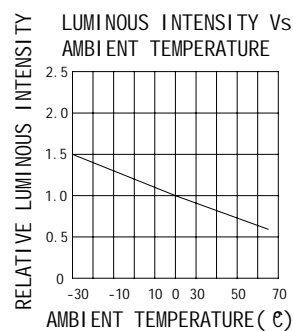
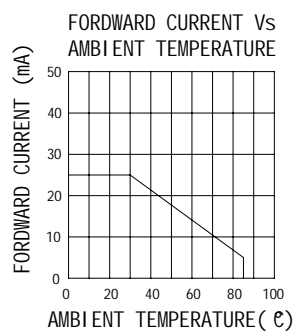
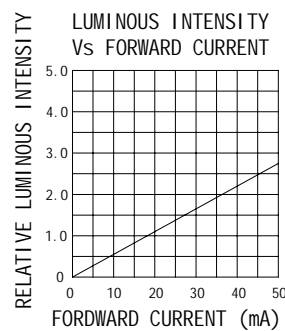
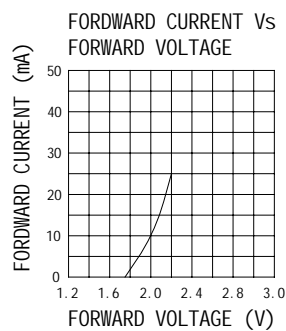



Super Bright Red

