

# SPECIFICATION FOR APPROVAL

MESSRS : SUHKWANG

Description	Item
SMD INDUCTOR	SC5845D_Series

\*\*\*\*\*

DATE : 2006. 03. 16.



株式  
會社

## 光 星 電 子



### HEAD OFFICE

KWANG SUNG ELECTRONICS CO.,LTD.

108, 4 - KA, WONHYO - RO, YONGSAN - KU, SEOUL, KOREA

TEL : 82 - 2 - 713 - 6001

FAX : 82 - 2 - 712 - 0001

82 - 2 - 711 - 2001

### R&D CENTER

KWANG SUNG ELECTRONICS H/K CO.,LTD. KOREA BRANCH

201, WORLD VENTURE TOWN 60 - 24, GASAN - DONG

GEUMCHUN - GU, SEOUL, KOREA

TEL : 82 - 2 - 2108 - 3590, 3595

FAX : 82 - 2 - 2108 - 3535

### HONG KONG OFFICE

KWANG SUNG ELECTRONICS H.K CO.,LTD.

UNIT7 - 9, 13/F, WAH WAI IND. CENTRE, 38 - 40

AU PUI WAN ST., FO TAN, N.T., HONG KONG

TEL : 852 - 2602 - 6609

FAX : 852 - 2602 - 6490

### CHINA FACTORY

SHEN ZHEN KWANG SUNG ELECTRONICS CO.,LTD.

SHITOUZHAN INDUSTRIAL ZONE, ZHUAN CHANG

VILLAGE, SHIYAN TOWN BAOAN DISTRICT,

SHENZHEN GUANG DONG PROVINCE, CHINA

TEL : 86 - 755 - 2765 - 4650

FAX : 86 - 755 - 2765 - 6007

MESSRS.: SUHKWANG	SMD INDUCTOR SPECIFICATION	DATE: 2006. 03. 16.
KSE Name: SC5845D Series		

1. ITEM : SMD CHOKE COIL (SC5845D Series)
2. DIMENSION (UNIT : mm)

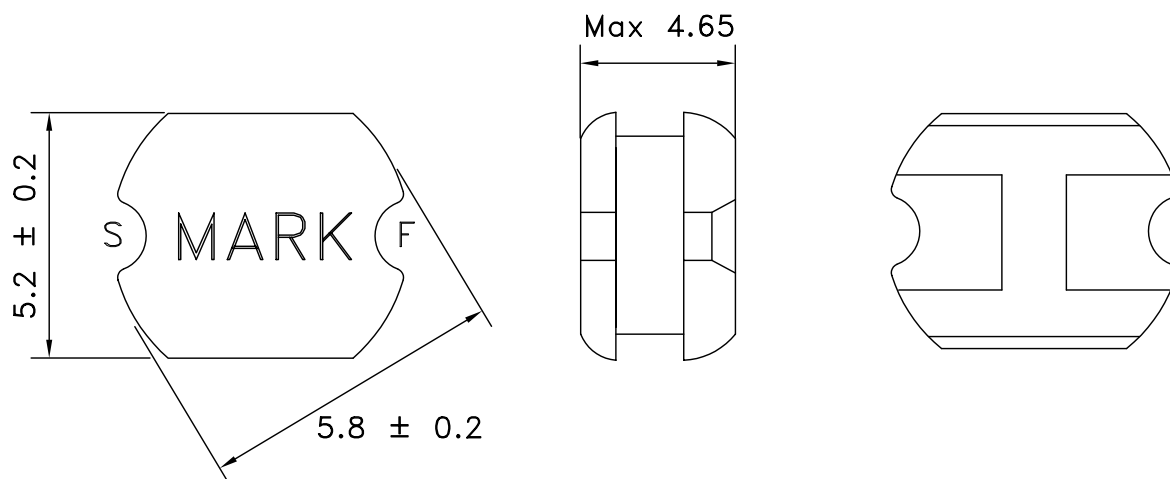

(SOLDER LAND PATTERN)

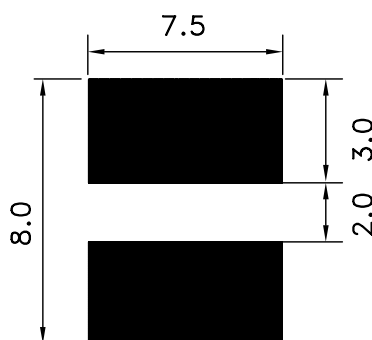

### 3. ORDERING CODE

SC5845D - 220 K

SC5845D : Series Name  
 220 : Inductance (220 = 22uH)  
 K : Tolerance

	DESCRIPTION	DRAWN	DESIGNED	CHECKED	APPROVED
				技術 06.03.16 權恩洙	技術 06.03.16 張東俊

MESSRS.: SUHKWANG

## SPECIFICATION

DATE: 2006. 03. 16.

KSE Name: SC5845D Series

## 4. MATERIALS

NO	PARTS	MATERIAL
1	CORE	DR 5.8 x 4.5 or Equiv.
2	WIRE	POLYURETHANE ENAMELLED COPPER

## 5. ELECTRICAL CHARACTERISTICS

Part number.	Inductance L( $\mu$ H)	Tolerance (%)	DC.R( $\Omega$ ) Max	Rated Current (A)
SC5845D-100L	10	$\pm 15\%$	0.1	1.5
SC5845D-120L	12	$\pm 15\%$	0.12	1.4
SC5845D-150L	15	$\pm 15\%$	0.14	1.3
SC5845D-180L	18	$\pm 15\%$	0.15	1.2
SC5845D-220K	22	$\pm 10\%$	0.18	1.1
SC5845D-270K	27	$\pm 10\%$	0.2	0.97
SC5845D-330K	33	$\pm 10\%$	0.23	0.9
SC5845D-390K	39	$\pm 10\%$	0.32	0.8
SC5845D-470K	47	$\pm 10\%$	0.37	0.72
SC5845D-560K	56	$\pm 10\%$	0.42	0.68
SC5845D-680K	68	$\pm 10\%$	0.46	0.61
SC5845D-820K	82	$\pm 10\%$	0.6	0.58
SC5845D-101K	100	$\pm 10\%$	0.7	0.52
SC5845D-121K	120	$\pm 10\%$	0.93	0.48
SC5845D-151K	150	$\pm 10\%$	1.1	0.4
SC5845D-181K	180	$\pm 10\%$	1.38	0.38
SC5845D-221K	220	$\pm 10\%$	1.57	0.35
SC5845D-331K	330	$\pm 10\%$	2.1	0.28

\* Measuring Freq. : 1 KHz

\* Maximum rated DC current is that which causes a 20% inductance reduction or temperature rising  $\Delta t=40^{\circ}\text{C}$  from the initial value.