

CORD END TERMINAL

● CORD END SLEEVES (Ferrule Terminal)

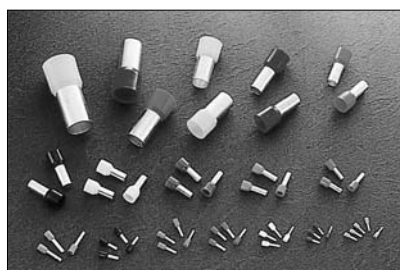

Material : Hight Conductivity Copper with Tin-Plated

Insulation : Polyamid

Dimmensions are according to DIN 46228.

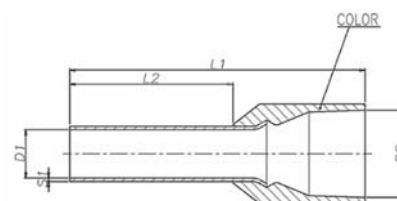

Part No	Conductor(mm)	Dimension(mm)					COLOR
		L1	L2	ØD1	S1	ØD2	
CE002506	0.25	10.0	6.0	0.75	0.15	2.0	BLUE
CE002508		12.0	8.0				
CE003406	0.34	10.0	6.0	0.80	0.15	2.0	TURQUOISE
CE003408		12.0	8.0				
CE005006	0.50	12.0	6.0	1.00	0.15	2.6	ORANGE
CE005008		14.0	8.0				
CE005010		16.0	10.0				
CE007506	0.75	12.0	6.0	1.20	0.15	2.8	WHITE
CE007508		14.0	8.0				
CE007510		16.0	10.0				
CE007512		18.0	12.0				
CE010006	1.00	12.0	6.0	1.40	0.15	3.0	YELLOW
CE010008		14.0	8.0				
CE010010		16.0	10.0				
CE010012		18.0	12.0				
CE015006	1.50	12.0	6.0	1.70	0.15	3.5	DARK RED
CE015008		14.0	8.0				
CE015010		16.0	10.0				
CE015012		18.0	12.0				
CE015018		24.0	18.0				
CE025008	2.50	14.0	8.0	2.20	0.15	4.2	BLUE
CE025010		16.0	10.0				
CE025012		18.0	12.0				
CE025018		24.0	18.0				
CE040010	4.00	17.0	10.0	2.80	0.20	4.8	GREY
CE040012		20.0	12.0				
CE040018		26.0	18.0				
CE060012	6.00	20.0	12.0	3.50	0.20	6.3	BLACK
CE060018		26.0	18.0				
CE100012	10.0	22.0	12.0	4.50	0.20	7.6	IVORY
CE100018		28.0	18.0				
CE160012	16.00	24.0	12.0	5.80	0.20	8.8	GREEN
CE160018		28.0	18.0				
CE250016	25.00	28.0	16.0	7.30	0.20	11.2	BROWN
CE250018		30.0	18.0				
CE250022		35.0	22.0				
CE350012	35.00	26.0	12.0	8.30	0.20	12.7	BEIGE
CE350016		30.0	16.0				
CE350018		32.0	18.0				
CE350025		39.0	25.0				
CE500020	50.00	36.0	20.0	10.30	0.30	15.0	OLIVE
CE500025		40.0	25.0				

CORD END TERMINAL

● NON-INSULATED CORD END SLEEVES



Material : Hight Conductivity Copper with Tin-Plated
Dimmensions are according to DIN 46228.

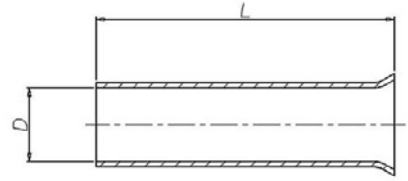

Part No	Conductor(mm ²)	Dimension(mm)	
		L	øD
NCE005006	0.50	6.0	1.0
NCE005008		8.0	
NCE007506	0.75	6.0	1.2
NCE007508		8.0	
NCE007510		10.0	
NCE010006	1.00	6.0	1.4
NCE010008		8.0	
NCE010010		10.0	
NCE010012		12.0	
NCE015007	1.50	7.0	1.7
NCE015010		10.0	
NCE015012		12.0	
NCE025007	2.50	7.0	2.2
NCE025010		10.0	
NCE025012		12.0	
NCE025015		15.0	
NCE040009	4.00	9.0	2.8
NCE040012		12.0	
NCE060010	6.00	10.0	3.5
NCE060012		12.0	
NCE060015		15.0	
NCE100012	10.00	12.0	4.5
NCE100015		15.0	
NCE100018		18.0	
NCE160012	16.00	12.0	5.8
NCE160015		15.0	
NCE160018		18.0	
NCE250012	25.00	12.0	7.3
NCE250015		15.0	
NCE250018		18.0	
NCE250025		25.0	
NCE350018	35.00	18.0	8.3
NCE350025		25.0	
NCE500018	50.00	18.0	10.3

CORD END TERMINAL

● INSULATED TWIN SLEEVES (Ferrule Terminal)

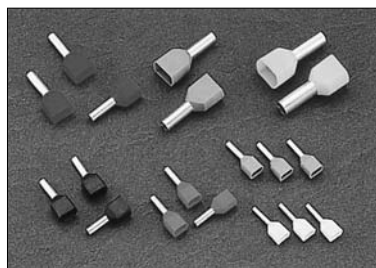

Material : E-Copper, Tinned
Insulation : Polyamid

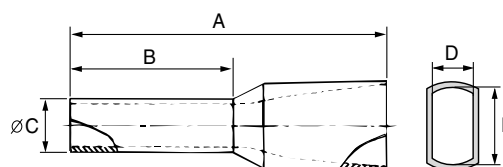

Part No	Conductor(mm ²)	Dimension(mm)					COLOR
		A	B	∅C	D	E	
CT2005008	2 × 0.50	15.0	8.0	1.80	2.00	4.2	WHITE
CT2007508	2 × 0.75	15.0	8.0	2.10	2.30	4.5	GREY
CT2007510		17.0	10.0	2.10	2.30	4.5	
CT2010008	2 × 1.00	15.0	8.0	2.35	2.65	4.8	RED
CT2010010		17.0	10.0	2.35	2.65	4.8	
CT2015008	2 × 1.50	16.0	8.0	2.60	2.90	5.9	BLACK
CT2015012		20.0	12.0	2.60	2.90	5.9	
CT2025010	2 × 2.50	18.5	10.0	3.20	3.40	7.0	BLUE
CT2025013		21.5	13.0	3.20	3.40	7.0	
CT2040012	2 × 4.00	23.0	12.0	4.10	3.40	7.8	GREY
CT2060014	2 × 6.00	26.0	14.0	5.20	3.40	9.0	YELLOW

● CRIMPING TOOLS

Part No		Available Wire
DET-04WF		0.5mm ² ~ 4mm ²
DET-16WF		6mm ² ~ 16mm ²
DET-086/TU		0.08mm ² ~ 6mm ²