

HYBRID STEPPING MOTOR TYPE 23HS3607-01

Performance & specifications				Wiring diagram
Step angle	1.8°±5%	Rated voltage	8.6 V	
Number of phase	4	Rated current	1.0 A	
Insulation resistance	100Mohm Min.(500V DC)	Resistance per phase	8.6 ohm±10%	
Insulation class	Class B	Inductance per phase	15 mH±20%	
Rotor Inertia	460 g.cm ²	Holding torque	1.2 Nm	
Mass	1.0 kg	Detent torque	70 mNm	

Dimensions unit=mm

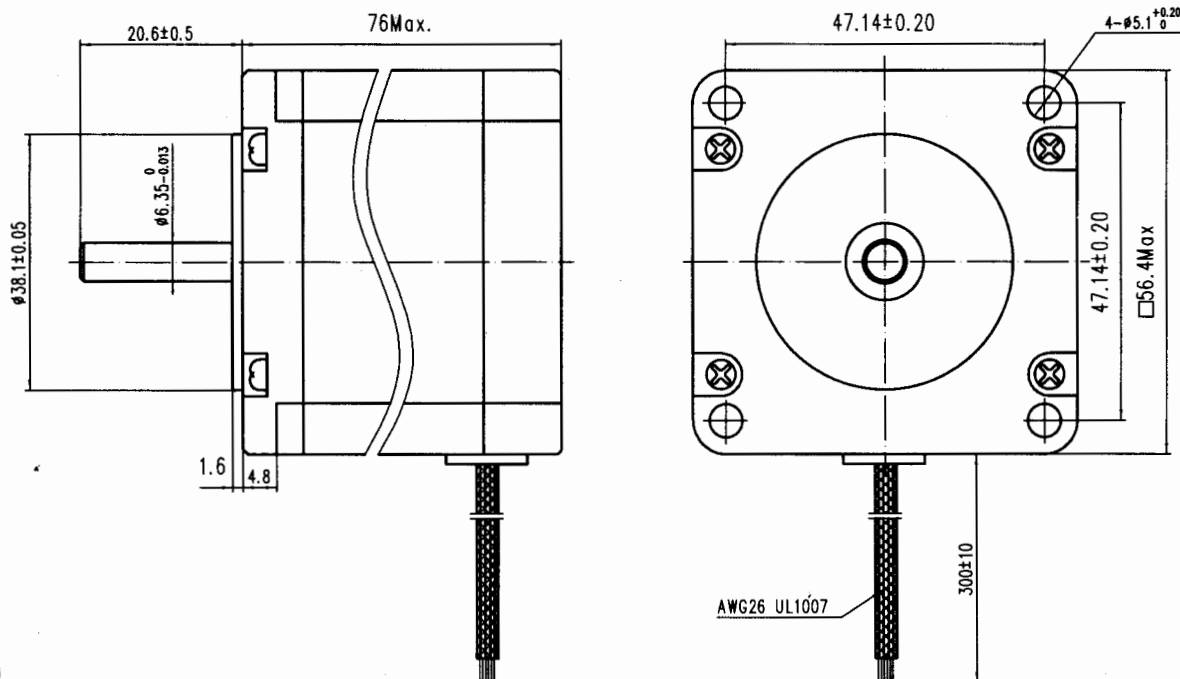

DRIVE SEQUENCE MODEL

STEP	A	B	C	D	O	M	
1	-	-	-	-	+	+	CCW
2	-	-	-	-	+	+	
3	-	-	-	-	+	+	
CW	4	-	-	-	+	+	

CW(CLOCKWISE)&CCW(COUNTER CLOCKWISE) ROTATION
WHEN SEEN FROM THE FLANGE SIDE OF THE MOTOR

Comment:

Rev.	Description	Date

MS9.005.001

STANDARD

APPROVE

张利军 07.7.13

DESIGN

张利军 07.7.13

TECHNOLOGY