

HYBRID STEPPING MOTOR TYPE 11HS3002-14

PERFORMANCE & SPECIFICATIONS

- Step Angle ----- $1.8^\circ \pm 5\%$
- Number of phase ----- 4
- Insulation resistance ----- 100Mohm Min.(500V DC)
- Insulation class ----- Class B
- Rotor inertia ----- $12\text{g}\cdot\text{cm}^2(0.066\text{oz}\cdot\text{in}^2)$
- Mass ----- 0.15 Kg(0.33 lb)
- Detent torque ----- 6 mNm(0.84 oz.in)
- Rated voltage ----- 3.25 V
- Rated current ----- 0.95 Amp (uni-polar)
- Resistance per phase ----- $3.4\ \Omega \pm 10\%$ (20°C)
- Inductance per phase ----- $1.6\ \text{mH} \pm 20\%$
- Holding torque --- (two phase on)
--- 65 mNm(9 oz.in)(uni-polar connection, 0.95Amp)

REV.

A

UNLESS OTHERWISE SPECIFIED:

FIRST ANGLE
PROJECTION

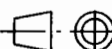

DIMENSIONS IN MILLIMETERS
UNTOLERANCED DIMENSIONS:

X ± 0.5 ANGLE $\pm 1^\circ$
X.XX ± 0.02

REVISION RECORD

REV.	DESCRIPTION	DATE

DIMENSIONS UNIT=mm

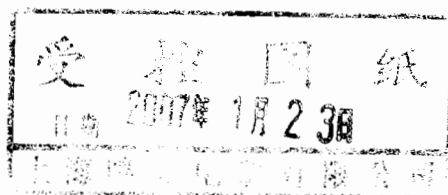
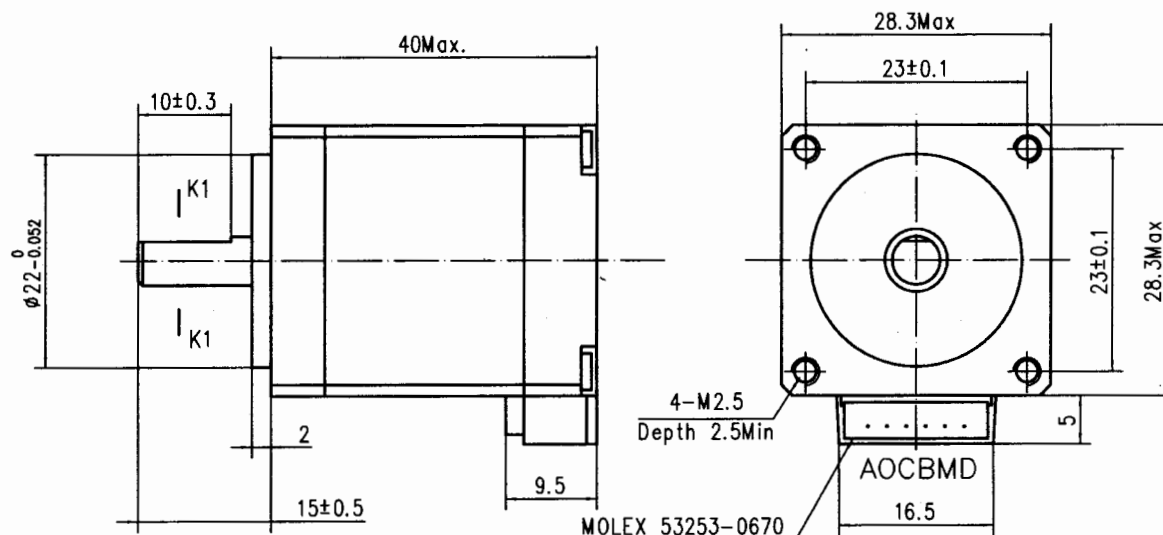

WIRING DIAGRAM

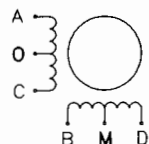

DRIVE SEQUENCE MODEL

UNI-POLAR FULL STEP

STEP	A	B	C	D	O	M
1	-	-			+	+
2		-	-		+	+
3			-	-	+	+
4	-			-	+	+

CCW

CW

CW(CLOCKWISE)&CCW(COUNTER CLOCKWISE) ROTATION
WHEN SEEN FROM THE FLANGE SIDE OF THE MOTOR

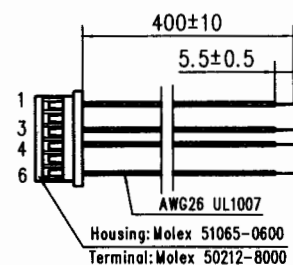
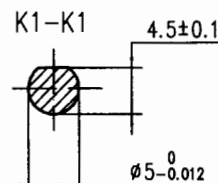

PIN NO.	COLOR
1	BLACK/黑
2	--
3	GREEN/绿
4	BLUE/蓝
5	--
6	RED/红

DESIGN MS9.005.001

STANDARD	APPROVE	DESIGN	DATE 2007.01.18	TECHNOLOGY
SHANGHAI MOONS' ELECTRIC CO., LTD.				SHEET 1 OF 1
				SCALE 1:1 DWG SIZE A4