



❖ SNFC0415P-Series

NEW!



□ Shape & Dimensions

3.8 (W)×3.8 (D)×1.5(H) (mm)

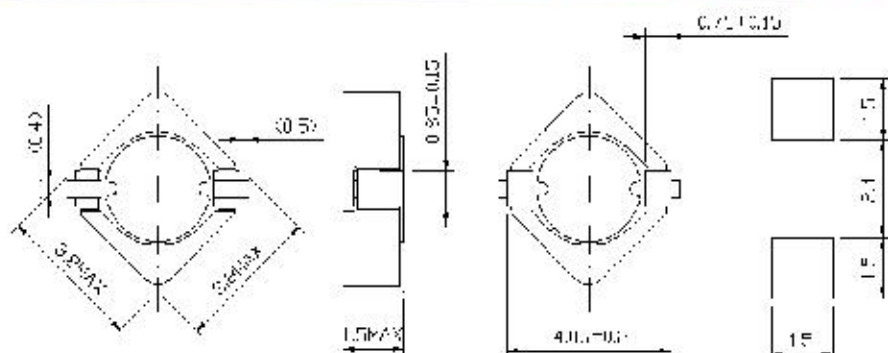

PCB Pattern (Unit:mm)

□ Standard Specifications

Part No.	stamp	Inductance	Tolerance	Resistance	Max. DCR	DC Superimposition current *1	Temperature rise current *2
部品番号	表示	インダクタンス (uH)	許容差	直流抵抗 (mΩ typ.)	最大直流抵抗 (mΩ)	直流重畳許容電流 (A)	温度上昇許容電流 (A)
SNFC0415P-1R5F	1R	1.5	±30%	53	70	2.33	2.35
SNFC0415P-3R3F	3R	3.3	±30%	100	130	1.53	1.68
SNFC0415P-4R7F	4R	4.7	±30%	150	195	1.30	1.36
SNFC0415P-5R6F	5R	5.6	±30%	165	210	1.15	1.31
SNFC0415P-6R8F	6R	6.8	±30%	238	305	1.06	1.08
SNFC0415P-8R2F	8R	8.2	±30%	258	330	0.97	1.04
SNFC0415P-100F	10	10	±20%	288	370	0.87	0.98
SNFC0415P-120F	12	12	±20%	388	500	0.80	0.84
SNFC0415P-150F	15	15	±20%	557	715	0.70	0.71
SNFC0415P-220F	22	22	±20%	683	880	0.59	0.63

*1 : DC_current based upon 30% inductance reduction from the initial value.

*2 : DC_current based upon 35°C temperature rise.

*3 : Coil operation temperature is -25°C ~ 120°C
(includes temperature when the coil is heated)